

STATESMAN

kitchen appliances



BIFF17030FF

**55CM 70/30 FROST-FREE INTEGRATED
FRIDGE FREEZER WHITE**

Instruction Manual

Please read these instructions carefully before use and retain for future reference.
Before switching on your appliance – Always check for any damage that may have
been caused in transit.

CONTENTS

Important Safety Instructions	3-7
Specification	8
Appliance Overview	9
Installation	10-11
Operating Instructions	12-17
Cleaning & Maintenance	18-19
Trouble Shooting Guide.....	20
Fuse Replacement	21
Disposal Information	21
Statesman Warranty Information.....	22

IMPORTANT SAFETY INSTRUCTIONS

Read and follow all of the instructions even if you feel you are familiar with the product, and find a place to keep this manual handy for future reference.

IMPORTANT: This product is intended for domestic use only; to store and freeze food products only. When using electrical appliances, basic safety precautions should always be followed:

Warning: Do not operate the appliance with a damaged cord or plug, after it malfunctions or has been dropped or damaged in any way. All electrical repairs must be carried out by a qualified electrician. Inadequate repairs may result in a major source of danger for the user and invalidate the warranty.

Warning: Keep ventilation openings, in the appliance or in the built-in structure, clear of obstruction.

Warning: Do not use mechanical devices or other means to accelerate the defrosting process, other than those recommended by the manufacturer.

Warning: Do not use electrical appliances inside the food storage compartments of the appliance, unless they are of the type recommended by the manufacturer.

Warning: Do not damage the refrigerant circuit.

Warning: When positioning the appliance, ensure the power cord is not trapped or damaged.

Warning: Do not locate multiple portable socket-outlets or portable power supplies at the rear of the appliance.

Warning: In order to avoid any hazards resulting from the instability of the appliance, it must be fixed in accordance with the instructions.

Warning: The refrigerant of this product is R600a which is flammable. Ensure when moving the appliance or during installation that the cooling system does not get damaged. R600a is an environmentally friendly and natural gas, but it is explosive. In the event of a leak, move your fridge away from open flames or heat sources and ventilate the room where the appliance is located for a few minutes.

Warning: To avoid a hazard due to instability of the appliance, it must be fixed in accordance with the instructions.

- While carrying and positioning the fridge, do not damage the refrigerant circuit.
- Do not store explosive substances such as aerosol cans with a flammable propellant in this appliance.
- This appliance is intended to be used in household and domestic applications such as:
 - staff kitchen areas in shops, offices and other working environments.
 - farm houses and by clients in hotels, motels and other residential type environments.
 - bed and breakfast type environments.
 - catering and similar non-retail applications.
- A specially grounded plug has been connected to the power cable of your refrigerator. This plug should be used with a specially grounded socket of 13 amperes.
- This appliance can be used by children aged from 8 years and above and persons with reduced physical, sensory or mental capabilities or lack of experience and knowledge if they have been given supervision or instruction concerning use of the appliance in a safe way and understand the hazards involved.
- Children shall not play with the appliance.
- Children aged from 3 to 8 years are allowed to load and unload refrigerated appliances.
- Children are not expected to perform cleaning or user maintenance of the appliance.
- Very young children (0-3 years old) are not expected to use the appliance, young children (3-8 years old) are not expected to use the appliance safely, unless continuously supervised.
- If the power cord is damaged, it must be replaced by the manufacturer, an authorised service agent or similar qualified persons, in order to avoid a hazard.
- This appliance is not intended for use at altitudes exceeding 2000m.

- Do not connect your appliance to the mains electricity supply using an extension lead.
- Do not use damaged, malfunctioning or worn plugs.
- Do not pull, bend or damage the cord.
- Do not use a plug adapter.
- This appliance is designed for use by adults. Do not allow children to play with the appliance or hang off the door.
- Never touch the power cord/plug with wet hands. This may cause a short circuit or electric shock.
- Do not place glass bottles or cans in the freezer compartment as they will burst when the contents freeze.
- Do not place explosive or flammable materials in your fridge. Place drinks with high alcohol content vertically in the fridge compartment and make sure their tops are tightly closed.
- When removing ice from the ice-making compartment, do not touch it. Ice may cause frost burns and/or cuts.
- Do not touch frozen goods with wet hands. Do not eat ice-cream or ice cubes immediately after they are removed from the freezer compartment.
- Do not re-freeze thawed frozen food. This may cause health issues such as food poisoning.

To avoid contamination of food, please respect the following instructions:

- Opening the door for long periods can cause a significant increase of the temperature in the compartments of the appliance.
- Clean regularly surfaces that come into contact with food and accessible drainage systems.
- Store raw meat and fish in suitable containers in the refrigerator, so that it is not in contact with or cannot drip onto other food.
- Two-star frozen-food compartments are suitable for storing pre-frozen food, storing or making ice cream and making ice cubes.
- One-, two- and three-star compartments are not suitable for the freezing of fresh food.

- If the refrigerating appliance is left empty for long periods, switch off, defrost, clean, dry, and leave the door open to prevent mould developing within the appliance.

Installation Warnings

- Check the operating voltage of 220-240 V at 50Hz. matches the household voltage, check the rating label and specification for further details. If in doubt, consult a qualified electrician.
- The plug must be accessible after installation.
- Your fridge freezer may have an odour when it is operated for the first time. This is normal and the odour will fade when your fridge freezer starts to cool.
- Insert the plug into a socket with an efficient ground connection. If the socket has no ground contact or the plug is not compatible, we recommend consulting a qualified electrician for assistance.
- The appliance must be connected to a properly installed fused plug socket. We do not accept responsibility for any damages that occur due to ungrounded usage.
- Place your fridge freezer where it will not be exposed to direct sunlight.
- Your fridge freezer must never be used outdoors or exposed to rain.
- Your appliance must be at least 50 cm away from stoves, gas ovens and heater cores, and at least 5 cm away from electrical ovens.
- It is not recommended to stand the appliance on a carpeted surface.
- If your fridge freezer is placed next to a deep freezer, there must be at least 2 cm between them to prevent humidity forming on the outer surface.
- Do not cover the body or top of the fridge freezer as this will block ventilation and affect the performance of the appliance.
- A clearance space of at least 150mm is required at the top of your appliance. Do not place anything on top of your appliance.
- Do not place heavy items on the appliance.
- Clean the appliance thoroughly before use (see Cleaning and Maintenance section).

- This product is intended to be used in proper kitchen units only.

Warning: This appliance must be earthed. The mains lead of this appliance has been fitted with a specially earthed plug.

Warning: Do not use the appliance without the fuse cover in position. Should the fuse need to be replaced, it must be replaced with a 13A fuse, ASTA approved to BS1362. The plug must be used with a specially earthed socket of 13 amperes. If there is no such socket in your house, please have one installed by an authorised electrician.

Warning: If your old fridge or freezer has a lock, break or remove the lock before discarding the appliance, because children may get trapped inside it and may cause an accident.



WARNING! During use, service, and disposal of the appliance, please pay attention to the symbol shown on the left, which is located on the rear of appliance (rear panel or compressor) and yellow or orange in colour. It's the risk of fire warning symbol. There are flammable materials in the refrigerant pipes and compressor. Ensure the appliance is nowhere near any fire sources during use.

SPECIFICATIONS

Supplier Name/Trademark	Statesman
Model Number	BIFF17030FF
Category Type	Integrated Fridge Freezer
Energy Efficiency Class	E
Annual Energy Consumption	218kWh/A
Total Net Storage Volume (Litre)	242
Freezing Capacity	3.3kg/24h
Fridge Net Storage Volume (Litre)	179.5
Freezer Net Storage Volume (Litre)	63
Applicable Star Rating of Freezer Compartment	4 Star
Refrigeration System	Frost Free
Temperature Rise Time	8 Hours
Climate Class	T/N
Noise Emission (dB)	41
Built-in Appliance	Yes
Voltage (V)	220-240
Wattage Power (W)	187
Frequency (Hz)	50

Ambient Room Temperature Limits

Class	Symbol	Ambient average temperature °C
Extended temperature	SN	+10 to +32
Temperature	N	+16 to +32
Subtropical	ST	+16 to +38
Tropical	T	+16 to +43

APPLIANCE OVERVIEW

- A. Refrigerator Compartment
- B. Freezer Compartment
- 1. Thermostat Control Dial
- 2. Lamp Cover
- 3. Turbo Fan*
- 4. Wire Rack*
- 5. Refrigerator Shelves
- 6. Crisper Drawer Cover
- 7. Crisper Drawer
- 8. Freezer Upper Drawer
- 9. Freezer Drawers
- 10. Ice Box Tray
- 11. Freezer Glass Shelves*
- 12. Bottle Shelf
- 13. Adjustable Door Shelf*/Door Shelf
- 14. Door Shelves
- 15. Egg Holder

* In some models

** This illustration is only for reference,
for details please check your
appliance.

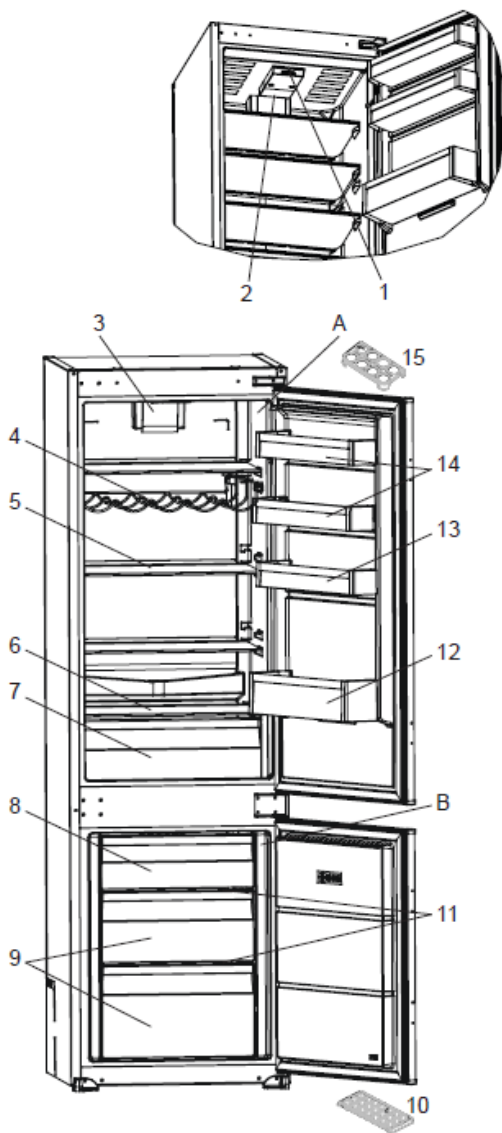

INSTALLATION

IMPORTANT: Unpack the appliance and check for any damage. Do not connect the appliance if it is damaged.

- This appliance must be left to stand in an upright position for at least 4 hours before being switched on for the first time to allow the coolant gases time to settle after the appliance is in place.
- The appliance should not be placed near to sources of heat e.g., cookers, radiators, direct sunlight or in any unheated rooms e.g., garages or outhouses, as extreme temperatures will affect the performance of your appliance.
- Make sure the plug is accessible after installation.
- Do not expose the appliance to damp conditions, open air, or rain.
- Do not lift the appliance by the pipes or the door when moving.
- If your fridge freezer is placed next to a deep freezer, there must be at least 2 cm between them to prevent humidity forming on the outer surface.
- Clearance of at least 150mm is required at the top of your appliance. Do not place anything on top of your appliance.
- Clean the appliance thoroughly before use.
- This product is intended to be used in fitted kitchen units only.

WARNING: It must be possible to disconnect the appliance from the mains power supply. The plug must be accessible after installation.



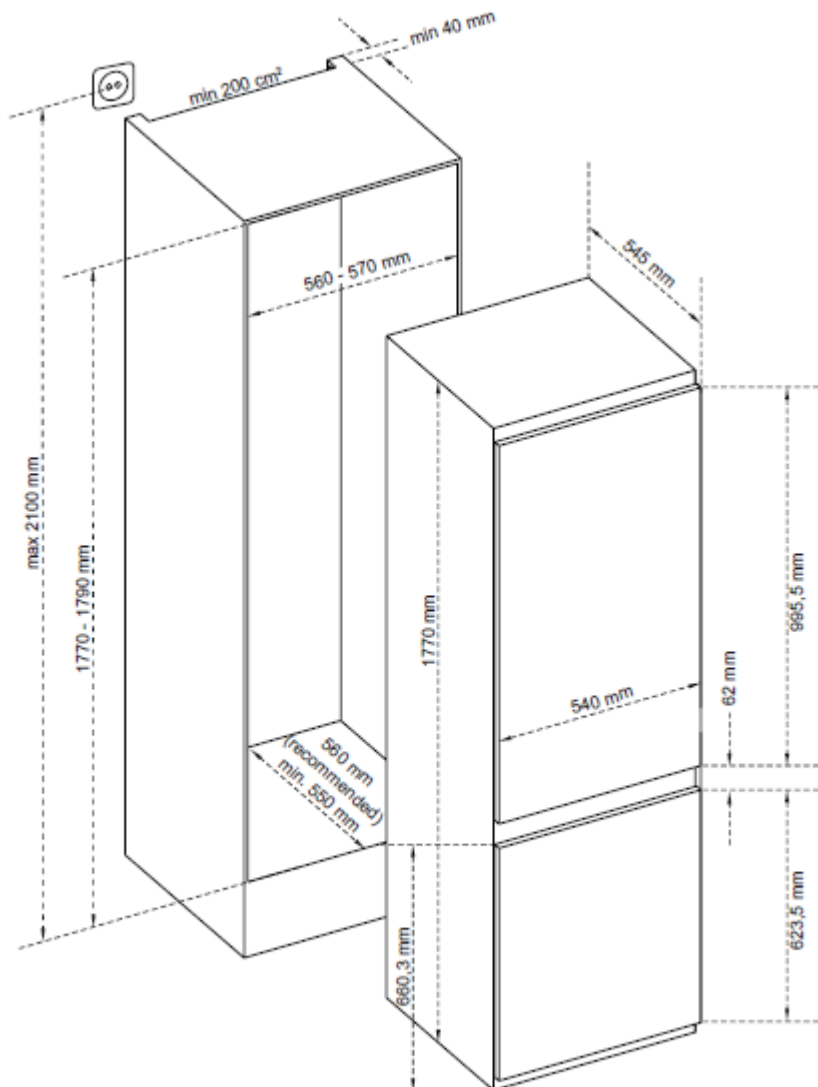

OPERATING INSTRUCTIONS

IMPORTANT: Before using the appliance for the first time, wash the interior and all the internal accessories with lukewarm water and some neutral soap to remove the typical smell of a new product, then dry thoroughly.

IMPORTANT: Do not use abrasive detergents or powders, as they will damage the finish of the appliance.

Information on The Frost-Free Technology:

Frost-Free refrigerators have a different operating system to static refrigerators. In normal (static) appliances, the humidity entering the refrigerator due to opening the door, and the humidity inherent in the food, causes frost build-up in the freezer compartment. To defrost the frost and ice in the freezer compartment, you are required to periodically switch off the refrigerator, place the frozen food in a separate cooled container, then remove the ice gathered in the freezer compartment.

The situation is completely different in No-frost appliances. A built-in fan blows dry and cold air evenly throughout the cooler and freezer compartments. The cold air disperses uniformly between the shelves, ensuring all your food is cooled equally, preventing humidity and frost build-up. Therefore, your Frost-Free refrigerator allows ease of use, in addition to its huge capacity and stylish appearance.

Thermostat Control Dial:

The thermostat automatically regulates the temperature inside the cooler and freezer compartments. Refrigerator temperatures can be obtained by rotating the Thermostat Control Dial to higher numbers; 1 to 3, 1 to 5 or SF (Maximum numbers on the thermostat depends on your product.)

Thermostat Settings:

- 1 – 2: For short-term storage of food in the freezer compartment.
- 3 – 4: For long term storage of food in the freezer compartment.
- 5 – MAX: For freezing fresh food. The appliance will work longer. Once the food is fully frozen, reset the thermostat to its original position.

Temperature Setting Warnings:

- Your appliance is designed to operate in the ambient temperature ranges stated in the manual, and on the Rating Label. It is not recommended that your fridge is operated in the environments which are outside of the stated temperature ranges. This will reduce the cooling efficiency of the appliance.
- Temperature adjustments should be made according to the frequency of door openings, the quantity of food kept inside the appliance and the ambient temperature in the location of your appliance.
- When the appliance is first switched on, allow it to run for 24 hours to reach operating temperature. During this time, do not open the door and do not keep a large quantity of food inside.
- A 5-minute delay function is applied to prevent damage to the compressor of your appliance when connecting or disconnecting to the mains, or when an energy breakdown occurs. Your appliance will begin to operate normally after 5 minutes.

Important Installation Instructions:

This appliance is designed to work in difficult climate conditions and is powered with 'Freezer Shield' technology which ensures that the frozen food in the freezer will not defrost even if the ambient temperature falls as low as -15 °C. So, you may then install your appliance in an unheated room without having to worry about frozen food in the freezer being spoilt. When the ambient temperature returns to normal, you may continue using the appliance as usual.

Turbo Fan (If Available):

Do not block the air inlet and outlet openings when storing food, otherwise air circulation provided by the turbo fan will be impaired.

Accessories:

Ice Tray:

- Fill the ice tray with water and place in the freezer compartment.
- After the water has completely frozen, you can twist the tray as shown below to remove the ice cubes.

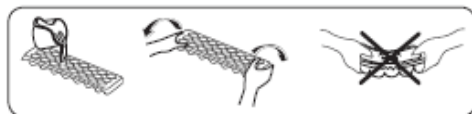

Bottle Holder:

Use the bottle holder to prevent bottles from slipping or falling over.

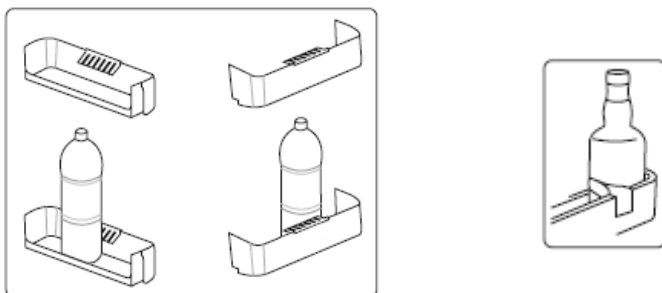

The Fresh Dial:

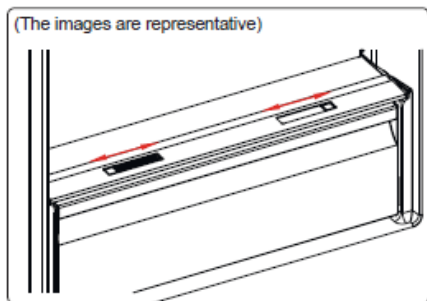

or

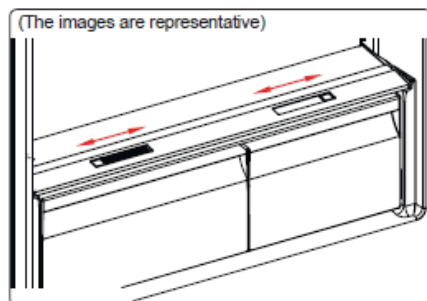

If the crisper drawer is full, the fresh dial located in front of the crisper drawer should be opened. This allows the air in the crisper drawer and the humidity rate to be controlled, to increase the life of food within. The dial, located behind the shelf, must be opened if any condensation is seen on the glass shelf.

Refrigerator Compartment:

- To avoid contamination of food, please follow the below instructions.
- Opening the door for long periods can cause a significant increase in the temperature.
- Regularly clean surfaces that can encounter food.
- Store raw meat and fish in suitable containers in the refrigerator, so that it is not in contact with or cannot drip onto other food.
- If the appliance is left empty for long periods, switch off, defrost, clean, dry and leave the door open to prevent mould developing within the appliance.
- Cooked dishes must remain covered when they are kept in the refrigerator. Do not place warm foods in the refrigerator.
- Ensure no items are in direct contact with the rear wall of the appliance as frost will develop and packaging will stick. Do not open the refrigerator door frequently.
- Store loose fruit and vegetable items in the Crisper Drawer.

- Storing fruit and vegetables separately helps prevent ethylene-sensitive vegetables (green leaves, broccoli, carrot, etc.) being affected by ethylene-releaser fruits (banana, peach, apricot, fig etc.).
- Do not put wet vegetables into the refrigerator.
- Storage time for all food products depends on the initial quality of the food and an uninterrupted refrigeration cycle before refrigerator storage.
- Do not allow food to touch the temperature sensor, which is located in the refrigerator compartment, in order to keep the refrigerator compartment at optimum temperature.
- For normal working conditions, it will be sufficient to adjust the temperature setting of your refrigerator to +4 °C.
- Foods should be placed in the refrigerator in closed containers or covered to prevent moisture and odours.

The table below contains general guidelines on the storage of food in refrigerated appliances.

Refrigerator Location	Type of Food
Door or door shelves of the fridge compartment	Foods with natural preservatives, such as jams, juices, drinks, condiments. No perishable foods.
Crisper drawer (salad drawer)	Fruits, herbs and vegetables. Do not store bananas, onions, potatoes, garlic in the refrigerator.
Fridge shelf – top	Foods that do not need cooking, such as ready-to-eat foods, deli meats, leftovers.
Fridge shelf – middle	Dairy products, eggs.
Fridge shelf – bottom chiller	Raw meat, poultry and fish. Short term storage only.
Freezer drawer/shelf	<ol style="list-style-type: none"> 1. Foods intended to be stored long-term. 2. Bottom drawer/shelf for raw meat, poultry, fish. 3. Middle drawer/shelf for frozen vegetables, chips. 4. Top drawer/shelf for ice cream, frozen fruit, frozen baked goods.

Freezer Compartment:

- The freezer is used for storing frozen food, freezing fresh food, and making ice cubes.
- Do not store fresh food next to frozen food as it can thaw the frozen food.
- Before freezing fresh food, divide it into portions that can be consumed in one sitting.
- Consume thawed frozen food within a short period of time after defrosting.
- Always follow the manufacturer's instructions on food packaging when storing frozen food.
- When purchasing frozen food, make sure that it has been stored under appropriate conditions and that the packaging is not damaged.
- Frozen food should be transported in appropriate containers and placed in the freezer as soon as possible.
- Do not refreeze thawed food. It may pose a danger to your health.
- If you attempt to open the freezer door immediately after closing it, you will find that it will not open easily. This is normal. Once equilibrium has been reached, the door will open easily.
- To use the maximum capacity of the freezer compartment, use the glass shelves for the upper and middle section, and use the lower basket for the bottom section.

Freezing Fresh Food:

- The freezer compartment is suitable for freezing fresh food and storing frozen food.
- The maximum amount of food that can be frozen in 24 hours is specified on the rating plate.
- The freezing process lasts 24 hours: during this period do not add other food to be frozen.
- Use the fast-freezing shelf to freeze fresh food (and any other food which needs to be frozen quickly). Fast freezing shelf is the top shelf of the freezer compartment.

CLEANING & MAINTENANCE

IMPORTANT: Switch off the electrical supply and remove the plug from the mains socket before carrying out cleaning or maintenance.

 **WARNING:** Do not use abrasive cloths, powders, household cleaners, bleach, or wax polish to clean the appliance as these can leave a smell in the appliance and can damage the exterior.

Before First Use:

Before using the appliance for the first time, wash the interior and all internal accessories with lukewarm water and some neutral soap to remove the typical smell of a brand-new product, then dry thoroughly.

Interior:

1. The interior of the refrigerator should be cleaned regularly to avoid odour.
2. Remove all food from the appliance and cover to help keep it cool.
3. Remove all the drawers and shelves carefully from the appliance and wash in warm clean water with a soft cloth and dry thoroughly. Never replace the drawers when still wet.
4. Use a soft cloth or sponge to clean the inside of the refrigerator, with some baking soda and warm water. Rinse with water and wipe clean.
5. Open the door and allow the interior to dry naturally before replacing shelves and the salad drawer. The appliance should be fully dry before it is switched back on.
6. Plug in, switch on and allow the temperature in the appliance to drop back to an adequate temperature.
7. Replace the food in the appliance.

Exterior:

Use a clean, soft cloth dampened in soapy water to wipe the exterior surface of the appliance and then dry thoroughly. Use a vacuum cleaner to remove dust from underneath the appliance and from around the compressor which is situated at the back of the appliance. Do this regularly to maintain adequate ventilation. Be careful not to damage the coolant system.

Defrosting:

- Your appliance performs automatic defrosting. The water formed as a result of defrosting passes through the water collection spout, flows into the water tray behind your appliance and evaporates.
- Make sure you have disconnected the plug of your appliance before cleaning the water tray.
- Remove the water tray from its position by removing the screws (if it has screws).
- Clean with soapy water. This will prevent odours forming.

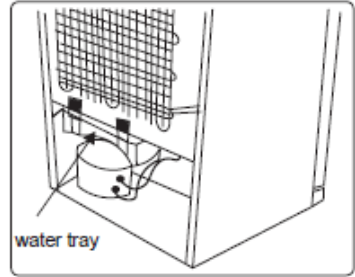

Door Seal:

- Use a clean, damp soft cloth to wipe the door seal and in between the creases, take care to avoid damaging the door seal as this will affect the performance of your appliance.

Replacing LED Lighting:

- To replace any of the LED's, please contact a qualified technician.

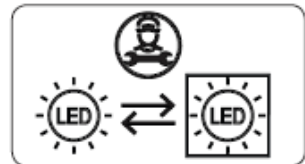

IMPORTANT: The numbers and location of the LED strips may change according to the model.

Power Cut:

In the event of a power cut keep the appliance door closed to maintain the temperature inside.

TROUBLE SHOOTING GUIDE

If you are having problems with your appliance, please use our trouble shooting guide below. If you are unable to resolve the issue using this guide please ring our Customer Service Department on 01473 277 508. Please have the model code and purchase information available.

Fault	Possible Cause	Solution
Appliance does not work.	Temperature control dial is set to '0'.	Set the dial to another number to switch on the appliance.
	Mains plug is not plugged in or is loose.	Insert mains plug correctly.
	Fuse has blown or is defective.	Check fuse, replace if necessary.
	Socket is defective.	Mains malfunctions are to be corrected by an electrician.
The food is too warm.	Temperature is not properly adjusted.	Refer to the 'Temperature Setting' section.
	Door was open for an extended period.	Open the door only as long as necessary.
	A large quantity of warm food was placed in the appliance in the last 24 hours.	Turn the temperature control to a colder setting temporarily and do not over fill with food.
	The appliance is near a heat source.	Please refer to the Installation section.
Appliance cools too much.	Temperature is set too cold.	Turn the temperature control dial to a warmer setting temporarily.
Unusual noises.	Appliance is not level.	Re-adjust the levelling feet.
	The appliance is touching the wall or other objects.	Move the appliance slightly.
	A component, e.g. a pipe, on the rear of the appliance is touching another part of the appliance or the wall.	If necessary, carefully bend the component out of the way.
Water on the floor.	Water drain hole is blocked.	Clean the drain hole.

FUSE REPLACEMENT

Fuse Replacement (Class I)

This appliance must be earthed. Remove the fuse cover with a small flat head screw driver. Take out the fuse and replace with a new fuse of the same Amp. Replace the fuse cover and push back into place.

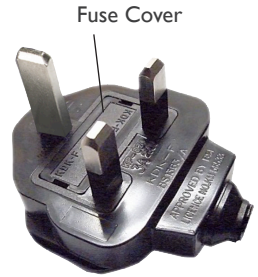

DISPOSAL INFORMATION

The European Directive 2012/19/EU on Waste Electrical and Electronic Equipment (WEEE), requires that old household electrical appliances must not be disposed of in normal unsorted municipal waste.

Old appliances must be collected separately in order to optimise the recovery and recycling of the materials they contain and reduce the impact on human health and the environment.

The crossed out “wheeled bin” symbol on the product reminds you of your obligation, that when you dispose of the appliance it must be separately collected. Consumers should contact their local authority or retailer for information concerning the correct disposal of their old appliance.



STATESMAN WARRANTY/GUARANTEE TERMS & CONDITIONS

THANK YOU FOR CHOOSING STATESMAN

As a valued customer we would like to offer you a **FREE 2-year warranty** to cover your product against any electrical or mechanical defects.

This means that in the unlikely event you develop a fault or problem with your product we will happily repair or replace the item free of charge.

To qualify for the guarantee, the product must be used for domestic household use only and in accordance with the instructions in the user manual. Any misuse of the product will result in the warranty being void.

The guarantee does not cover accidental damage, misuse, neglect, tampering or incorrect adjustment or installation.

The guarantee will be rendered invalid if the product is resold, has had its serial number or rating label removed (or has an invalid serial number or rating label), or if an unauthorised person has carried out any repairs or alterations.

The warranty does not cover accessories or consumable parts that require replacement under normal use. This includes shelving, dials, filters, belts and trays etc.

In the unlikely event of a breakdown please refer to the Troubleshooting Guide in your user manual and check all plugs, fuses and the electricity supply.

If you still require assistance, please contact our Customer Service Department on **01473 277 508** or write to us at the following address:

**Customer Service Department
38 Bluestem Road, Ransomes Industrial Estate, Ipswich, IP3 9RR**

Please quote the Product Code and the PO number on the rating label and give details of the exact fault. We will then decide whether to replace the item.

IMPORTANT NOTE: Before we arrange the replacement, you will be required to return a copy of your proof of purchase. Please retain your original.

If an item is replaced within the agreed warranty period, the warranty for the replacement item will be calculated from the purchase date of the original.

In the event that the product is inspected, and no fault is found, or the product is not within the guarantee period you will be charged for the repair and any carriage costs.

**UK
CA**

STATESMAN
— kitchen appliances

**38 Bluestem Road, Ransomes Europark, Ipswich, IP3 9RR
EU: Castle Electrical Factors Ltd., Dundalk, A91 KA9R, IR**

01473 277 508

52488083