

# STATESMAN

kitchen appliances



## FWD08514W 8KG/5KG WASHER DRYER WHITE Instruction Manual

Please read these instructions carefully before use and retain for future reference.  
Before switching on your appliance – Always check for any damage that may have been caused in transit.

## CONTENTS

<b>Important Safety Instructions .....</b>	<b>3-6</b>
<b>Specification Table .....</b>	<b>7</b>
<b>Appliance Overview.....</b>	<b>8-9</b>
<b>Installation.....</b>	<b>10-16</b>
<b>Cycles and Functions.....</b>	<b>17-20</b>
<b>Operating Instructions .....</b>	<b>21-23</b>
<b>Cleaning &amp; Maintenance .....</b>	<b>24-26</b>
<b>Troubleshooting.....</b>	<b>27-28</b>
<b>Product Fiche.....</b>	<b>29-30</b>
<b>Fuse Replacement.....</b>	<b>31</b>
<b>Disposal Information.....</b>	<b>32</b>
<b>Statesman Warranty Information.....</b>	<b>33</b>

# IMPORTANT SAFETY INSTRUCTIONS

Before using the washer, please read and follow these instructions even if you feel you are familiar with the product. Keep these instructions for any future reference and store this manual in a safe and dry place. These instructions and the washer itself provide important safety warnings, to be observed at all times. The manufacturer declines any liability for failure to observe these safety instructions, for inappropriate use of the washer or incorrect setting of controls.

## General Safety

When using electrical appliances, basic safety precautions should always be followed:

- This washer is intended for household and domestic use.
- Always unplug the machine and turn off the water supply and mains power socket after use.
- To ensure your safety, power plug must be inserted into an earthed three-pin socket. Check carefully and make sure that your socket is properly and reliably earthed.
- The water and electrical supply must be connected by a qualified technician in accordance with the manufacturer's instructions and local safety regulations.
- Unplug the power plug from the mains power socket before cleaning or performing maintenance.
- Do not use any socket with rated current less than 10A.
- Do not use extension leads, multiple sockets or adapters.
- Do not operate this appliance if the power cord or plug is not working properly or if it has been dropped or damaged.
- If the power cord is damaged, it must be replaced with an identical one by the manufacturer or a qualified technician in order to avoid a hazard.
- Never pull the power plug with wet hands or if barefooted.
- The washer is not intended to be operated by means of an external switching device, such as a timer, or separate remote-controlled system.
- When moving, do not lift the washer by the dials or detergent drawer, without lifting it by the worktop or top lid; during transport, never rest the door on the trolley.
- Do not install the washer where it may be exposed to extreme conditions, such as: poor ventilation, temperatures below 5 °C or above 35 °C.
- Keep children away from the installation site. After unpacking the washer, make sure that it has not been damaged during transport. In the event of problems, contact the dealer or your nearest After-Sales Service. Once installed, packaging waste (plastic, styrofoam parts etc.) must be stored out of reach of children - risk of suffocation.
- Children of less than 3 years should be kept away from the appliance.
- Children 3-8 years should be kept away from the washer unless continuously supervised.
- The appliance can be used by children aged 8 years or above and persons with

reduced physical, sensory or mental capabilities, lack of experience or knowledge if they have been given supervision or instruction concerning use of the appliance in a safe way and understand the hazards involved. Children shall not play with the appliance and cleaning and user maintenance shall not be made by children without supervision.

- Keep all laundry detergents (including bleach, fabric softener, etc.) out of the reach of children.
- Check the machine before every operation to ensure animals and children have not climbed into the appliance.
- Do not load the washer above the maximum capacity (kg of dry cloth) indicated in the programme table (page 17).
- Glass door may be hot during operation. Keep children and pets far away from the machine during the operation, and do not use in a very wet rooms or rooms with explosive or caustic gas.
- Remove all packaging and transport bolts before using the appliance. Otherwise, serious damage may be caused.
- Do not wash or dry articles that have been cleaned in, washed in, soaked in or dabbed with combustible or explosive substances (such as wax, oil, paint, gasoline, degreasers, dry-cleaning solvents, kerosene, etc.) This may result in a fire or explosion.
- Fabric softeners, or similar products, should be used as specified by the fabric softener instructions.
- The washer dryer is not to be used if industrial chemicals have been used for cleaning.
- Do not machine wash fiberglass materials (such as curtains and windows coverings). Small particles may remain in the washer and stick to fabrics in other wash loads causing skin irritation.
- The exhaust air must not be discharged into a flue which is for exhausting fumes from the appliances burning gas or other fuels.
- This appliance is for indoor use only. Do not install this in an outdoor environment, not even where the area is sheltered because it may be very dangerous to leave it exposed to wet environments.
- It isn't intended for built-in applications.
- The opening must not be obstructed by a carpet.
- The appliance shall not be installed in bathrooms, very wet rooms or rooms with explosive or caustic gases.
- Appliances with a single inlet valve can only be connected to the cold-water supply. Appliances with double inlet valves should be correctly connected to the hot water and cold-water supply.
- Power plug must be accessible after installation.
- The appliance must not be installed behind a lockable door, a sliding door or a door with a hinge on the opposite side to that of the washer dryer.
- Be careful when unloading the washer. Water may reach very high temperatures during the wash cycle.

- The appliance shall not be installed in an unsafe or wet place.
- The product is only for home use and is only designed for textiles suitable for machine washing and drying.
- Do not climb onto or sit on top of the appliance.
- Do not lean against the machine door or use it as a step.

**Cautions during handling the appliance:**

- Transport bolts shall be reinstalled to the machine by a qualified personnel.
- The accumulated water shall be drained out of the appliance.
- Handle the machine carefully. Never hold each protruded part on the appliance while lifting including the appliance door.
- This appliance is heavy, transport with care.
- Do not insert hands into the running water extracting tub.
- Do not reach into the washer if the wash drum is moving.
  
- Please do not close the door with excessive force. If it is difficult to close the door, please check there is no blockage in the door.
- It is forbidden to wash carpets and rugs.
- Do not temper with the controls whilst programme is running.
- Before using the machine, the product should be calibrated.
- Before washing clothes for the first time, run the appliance on one full cycle without clothes.
- Flammable and explosive or toxic solvents are forbidden. Gasoline and alcohol etc. shall not be used as detergents. Please only select detergents suitable for machine washing.
- Do not use any solvents (e.g. turpentine, benzene, gasoline and alcohol), detergents containing, scouring powder, glass, general purpose cleaner, or flammable fluids; do not machine wash fabric that have been treated with solvents or flammable liquids.
- Make sure all pockets are emptied before placing them, into the appliance. Sharp and rigid items such as coins, brooch, nail, screws etc. may cause serious damage to this appliance.
- Please check the water inside the drum has been drained before opening the door. Please do not open the door if there is any water visible.
- Be careful of burning when the product drains hot washing water.
- After the programme is completed, please wait for two minutes before opening the door.
- Never refill the water by hand during washing.
- If fabrics contain vegetable oil or cooking oil or have been contaminated by hair care products, these should be washed in hot water with extra detergent before tumble drying. This will reduce the risk of a hazard.
- Do not dry unwashed items in the appliance.

- Items that have been soiled with substances such as cooking oil, acetone, alcohol, petrol, kerosene, spot removers, turpentine, waxes and wax removers should be washed in hot water with an extra amount of detergent before being dried in the appliance.
- Items such as foam rubber (latex foam), shower caps, waterproof textiles, rubber backed articles and clothes or pillows fitted with foam rubber pads should not be dried in the machine.
- Fabric softeners, or similar products, should be used as specified by the fabric softener instructions.
- It takes 15s or more for complete draining of the water extracting chamber tub
- The final part of a washer dryer cycle occurs without heat (cool down cycle) to ensure the items are left at a temperature that ensures the items will not be damaged.
- Remove all objects from pockets such as lighters and matches before using the appliance.

 **WARNING:** Never stop a washer dryer before the end of the drying cycle unless all items are quickly removed and spread out so that the heat is dissipated.

- The new hose-sets supplied with the appliance should be used and old hose-sets should not be reused.
- The washer must be installed and operated in a room with the drain.
- Before any maintenance is performed on the appliance, unplug it from the mains power socket and turn the socket off.
- In the event of a fault or malfunction, turn off the appliance, close the water tap and do not tamper with the machine. Immediately contact the Customer Service Centre and only use original spare parts. Failure to observe these instructions may jeopardise appliance safety.
- Certain internal parts are intentionally not grounded and may present a risk of electric shock during servicing. Service personnel – Do not touch the following parts while the appliance is energized: Control board, heat sink, motor, inlet valve and pump.





 **WARNING:** The company denies all liability if and when these norms are not respected.

## PRODUCT SPECIFICATION TABLE / FICHE

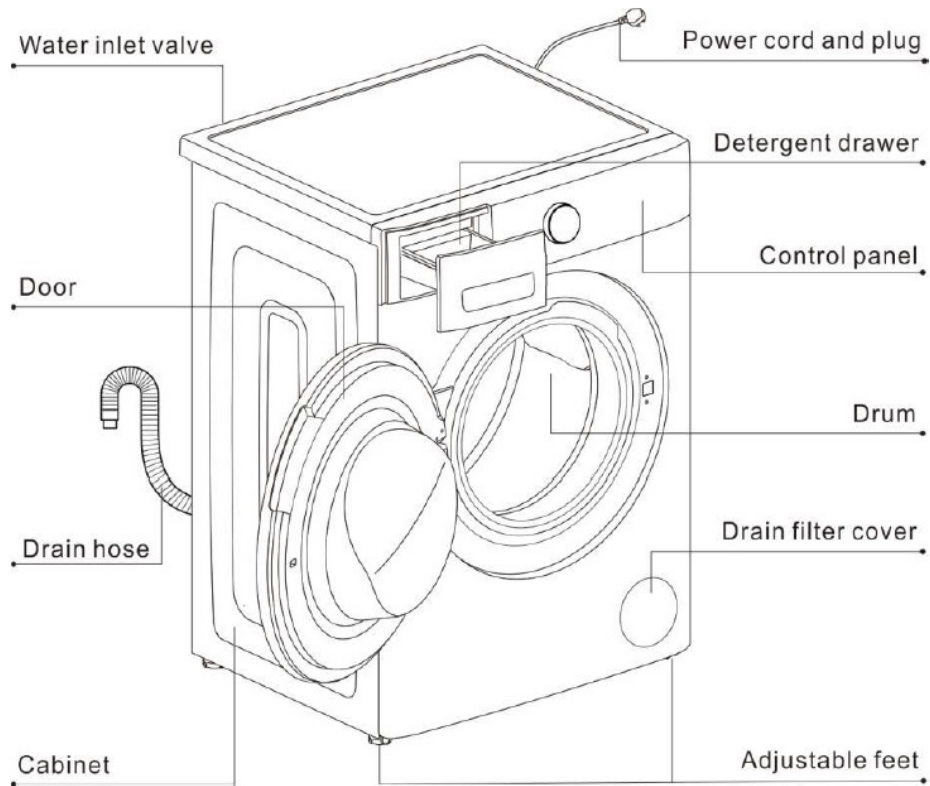
<b>Product Brand</b>	STATESMAN
<b>Product Name</b>	8kg/5kg Washer Dryer White
<b>Model Code</b>	FWD08514W
<b>Power</b>	2000W
<b>Rated Power Supply</b>	220-240V
<b>Rated Frequency</b>	50Hz
<b>Noise Level</b>	76dB
<b>Rated Washing Capacity</b>	8kg
<b>Drying Capacity</b>	5kg
<b>Max Spin Speed</b>	1400 RPM
<b>Energy Rating</b>	Wash=A Dry=D
<b>Steam Function</b>	Y
<b>Delay Timer</b>	Y – 24hrs
<b>Eco 40-60</b>	Y
<b>Inlet Pipe Length</b>	1.5m
<b>Product Dimensions (mm)</b>	H:847 x W:600 x D:520
<b>Net Weight</b>	60kg
<b>Drum Diameter</b>	53cm
<b>Cord Length</b>	1.9m
<b>Noise Level</b>	76dB
<b>Off-Mode</b>	0.5W
<b>Standby-Mode</b>	0.5W
<b>Inner Door Diameter</b>	330mm
<b>Outer Door Diameter</b>	480mm

# APPLIANCE OVERVIEW

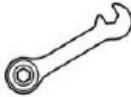

User manual	Water inlet hose	Wrench	Cover caps
1copy	1pcs	1 pcs	4pcs
			



## Control Panel and Display

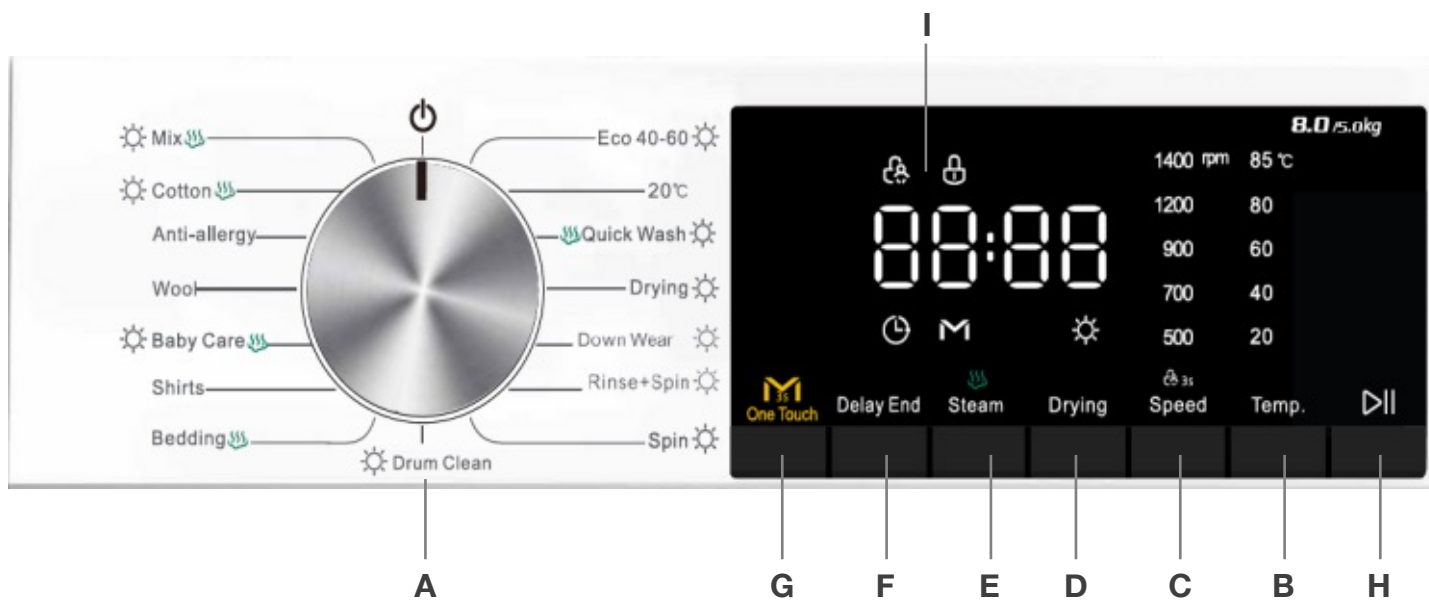

- A. Wash Cycle Selector
- B. Temperature Setting
- C. Speed Setting
- D. Drying Setting
- E. Steam Setting
- F. Delay End
- G. One Touch
- H. Start/Pause
- I. Timer Display

## Display

- 1. Temperature Options
- 2. Speed Options
- 3. Door Lock
- 4. Child Lock
- 5. Delay End
- 6. One Touch
- 7. Dry
- 8. Timer Display

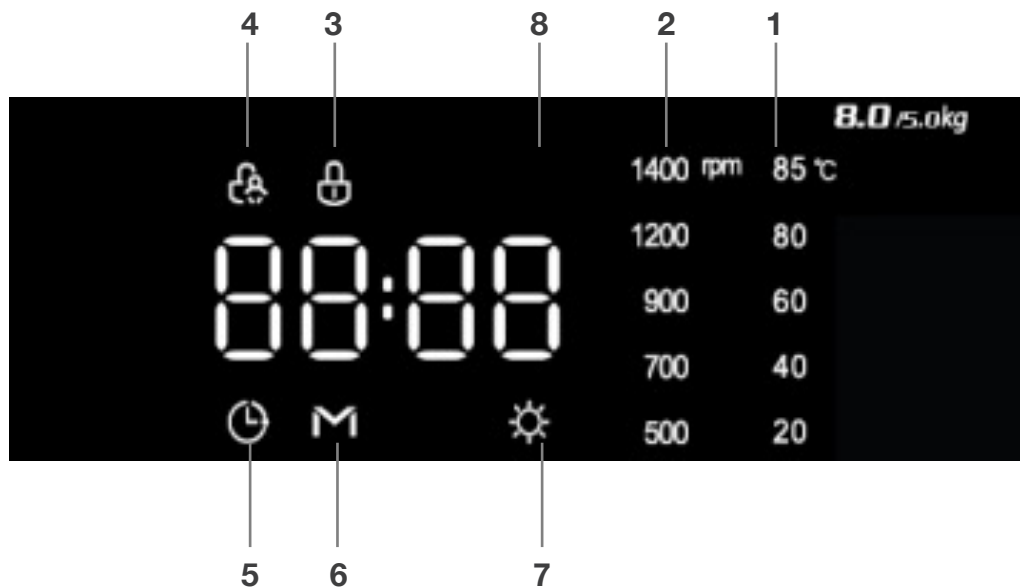

## INSTALLATION

Read these instructions carefully, they contain vital information relating to the safe installation and operation of the appliance.

Follow these instructions carefully to ensure proper installation of the appliance and to prevent accidents when doing laundry.

The washer must be handled and installed by two or more persons - risk of injury. Use protective gloves to unpack and install - risk of cuts.

 **WARNING:** Stability is important to prevent the product from moving! Make sure that the product isn't standing on the power cord.

### Unpacking The Washing Machine

 **WARNING:** Packaging material (e.g. Films, Styrofoam) can be dangerous for children. There is a risk of suffocation! Keep all packaging well away from children.

1. Remove the appliance from its packaging.
2. To remove the bottom tray of the packaging, do not tip the appliance onto its front side. When laying the appliance down to remove the carton base, protect the side of the appliance and lay it down carefully. Never lay the appliance on its back or front.
3. Make sure that the appliance has not been damaged during shipping. Make sure you have received all the items shown under the product overview section. If the appliance was damaged during shipping or you do not have all of the items, contact the retailer and do not proceed any further with the installation process.

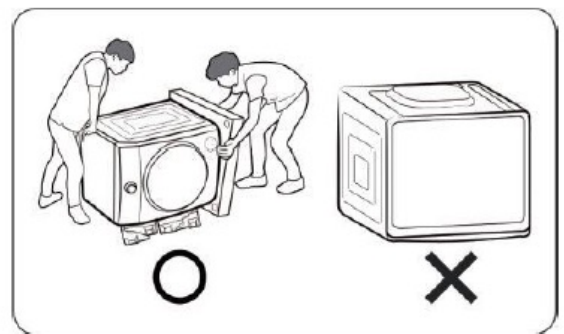

 **WARNING:** Packing materials can be dangerous to children. Keep all packaging material (plastic bags, polystyrene etc.) well out of children's reach.

### Carrying the appliance

1. Do not carry the appliance yourself without help, always have someone else to help carry the appliance with you.
2. Tilt the appliance backwards, one person stands behind the appliance and holds the protruding part of the top plate and the other person will hold the bottom of the appliance in front.
3. To prevent personal injury or strain, wear protective gloves whenever lifting or carrying the unit.
4. When moving the appliance, do not allow the front of the appliance to contact the trolley frame



## Removing the transport bolts

### Damage to the appliance or injury is possible

- The appliance is secured for transport with transport bolts. Transport bolts that are not removed can damage the drum during operation of the washer, the appliance will vibrate, and it will be much noisier during the spin cycles if the transport bolts are not removed before use. Be sure to remove all 4 transport bolts completely before first use. Keep the transport bolts. If a pedestal was purchased with the appliance, it must be installed first, prior to removing the transport bolts.

### Pedestal installation instructions

In order to prevent transport damage during later transport, be sure to re-install the bolts before transport.

1. Undo the four transport bolts A by the wrench (supplied) and remove them.
2. Remove the four spacer tubes B. During the removal of the bolts occasionally spacer tubes fall inside the machine, these can be removed by tilting the machine forward and recovering them from the floor or inside of the base of the machine.
3. Cover the open transport bolt holes with the four cover caps C which you will find in the plastic bag containing the accessories.

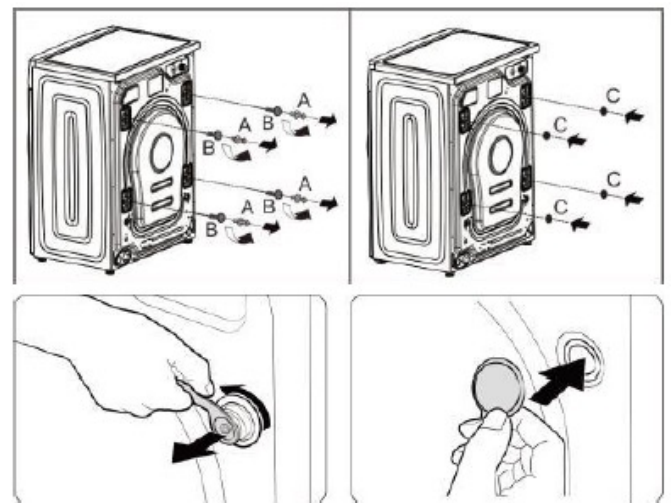

Keep all the parts in a safe place: you will need them again if the washer needs to be moved to another location.

**Please Note:** Transport the washer for the prevention of breakage as below:

### Choosing the right location

#### Locations requirement

- The machine should be installed on solid and even floor, never put the machine on carpet or on soft wood floor. Do not install the machine on the homemade plinth, if the installation location cannot be changed, the plinth must be improved as required, such as enlarge the size, secure with brackets. Never put the machine on the separate brackets. It is possible the machine moves a little by the factors of overloading, situation of the plinth (wet) and so on, so it will on risk the machine falls down from the plinth after working for a period of time.
- Keep the environment dry and vented.
- The appliance must be installed and operated in a room with the drain.
- Never put small appliances, such as a microwave oven: and/or jar cooker, on the machine.
- Keep the machine away from heat sources such as candles, cooking stove; and avoid direct sunlight.
- Never put the pressure containers on the machine.
- Never put the machine over the opening of an uncovered drainage.

- After installation of the washer, wait a few hours before starting it so that acclimates to the environmental conditions of the room.

### Clearance requirement

- Install the appliance with easy access to the power plug and socket.
- Install the appliance where there is enough space around it.
  - a) 3cm or more above
  - b) 5cm or more behind
  - c) 5cm or more on the left side
  - d) 5cm or more on the right side
  - e) 70cm or more

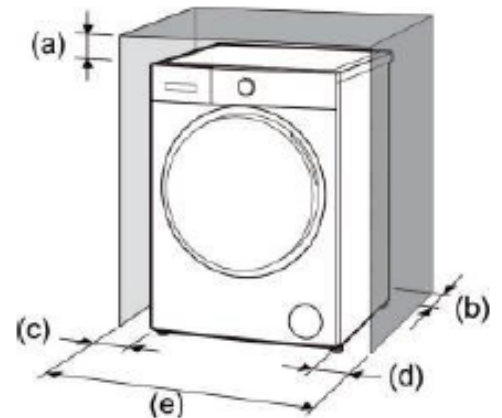

**CAUTION:** Do not let metallic portions of the appliance come into contact with metal sinks or other appliances.

### Leveling the appliance

#### Importance of levelling the appliance

The appliance uses high spin speeds to remove water at the end of the wash cycle. It is important that the appliance is level and that the appliance feet press with equal pressure against the floor. This will help assure the quietest, most vibration-free use of the appliance.

#### Follow these steps:

1. Install the appliance on a level and solid surfaces. Preferably in a corner of a room.
2. If the floor is uneven (or not level), adjust the appliance feet as required to level the appliance. Do not place anything under the appliance feet to help level the appliance.
3. Extend the appliance feet no more than is necessary. The more the feet are extended, the more vibration the appliance will experience. Start with the appliance feet turned all the way in and adjust each foot as necessary.
4. Use a spirit level (no supplied) to check the top of the appliance to make sure it is level side to side and rear to front.
5. Press down on each corner of the appliance top to make sure the appliance doesn't "wobble". There should be no "give" or movement. All the appliance feet should press equally against the floor. This is just as important as the appliance being level to prevent vibration.
6. When the appliance is level and does not wobble, lock the appliance feet in place by tightening the locknuts against the water bottom. Be sure to do this without changing the height of the foot (hold the foot while tightening the locknut).



## Connecting the electricity and water supplies

### Connecting the water inlet hose

1. Connect one end of the water inlet hose to a cold water tap and tighten by hand (see figure). Before performing the connection, allow the water to run freely until it is perfectly clear.
2. Connect the other end of the water inlet hose to the water inlet valve on the rear of the appliance and tighten by hand.
3. Turn on the tap slowly and make sure there are no leaks.

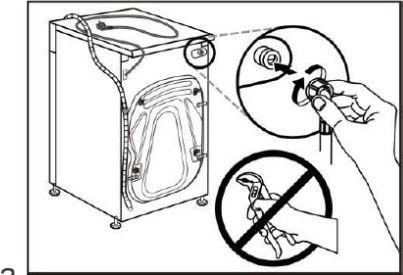
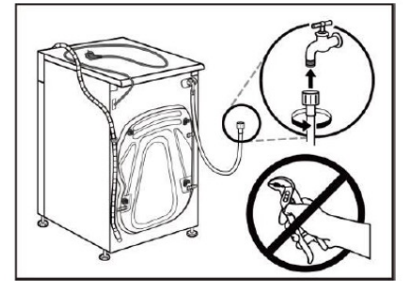

**WARNING:** Do not twist, squash, modify or cut the hose.



**WARNING:** Tighten the end of the hose firmly by hand.



**WARNING:** The supply water pressure must be in the 0.03-1.0MPa range. If the water pressure exceeds this value, please fit a pressure reducing valve.



**WARNING:** If the hose is not long enough, contact a specialized shop or a qualified technician.



**WARNING:** Never use a second-hand water inlet hose.

**WARNING:** Use the new water inlet hose supplied with the appliance.

### Connecting the drain hose

Height of the drain point – Height difference between the floor and drainage point: min 60cm (24 in) and max (39 in).

Attach the drain hose to the elbow, position the elbow on the drain hose 4" (100mm) from the end of the hose as shown. Insert this section of the drain hose into the drainpipe. If the hose is pushed down too far, this may cause the washer to self-siphon i.e. continuously empty as it is filling. Secure the elbow and hose with a cable tie to keep the hose from coming out of the drainpipe during use.

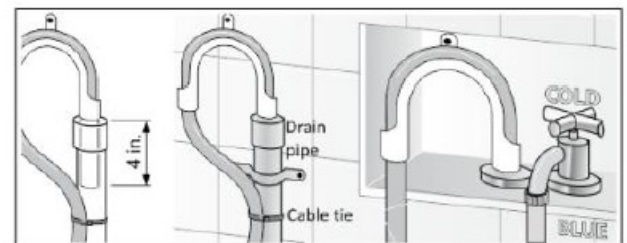
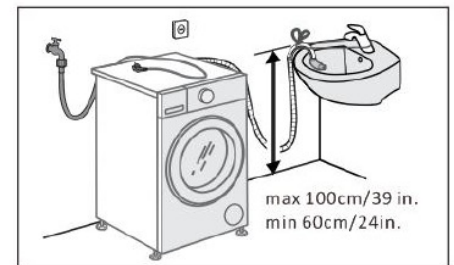

Types of drainage hookups:

- Standpipe
- Sink siphon

Secure the drain hose to the sink siphon using a 0.9-1.6 in (20-40mm) hose clip (available from a hardware store).

- Wash basin

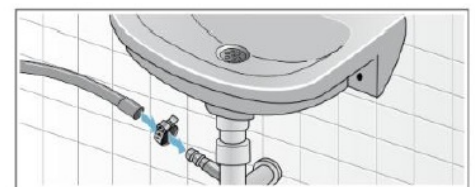

**WARNING – POTENTIAL SCALDING**

When washing at high temperatures, there is a risk of scalding if you touch hot suds, e.g. when pumping out hot suds into a wash basin. Do not reach into the hot studs.

**Please Note:** Appliance damage/ damage to textiles

If the end of the drain hose touches the discharged water (water drained from the washer), it (the discharged water) can be sucked back into the washer and may damage the appliance or textiles.

Make sure that:

- There is no stopper in the sink drain.
- The end of the drain hose does not touch the discharged water.
- The sink drain is free flowing and not partially blocked.
- Attach the drain hose securely to the wash basin.

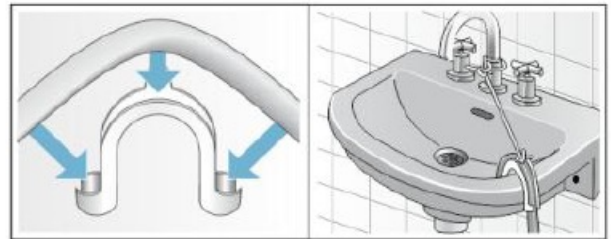

Secure the drain hose with a cable tie to the drainpipe, wash basin, etc., so the hose does not pull out from the force of the water.

**We advise against the use of drain hose extensions: in case of absolute need, the extension must have the same diameter as the original hose and must not exceed 250cms in length.**

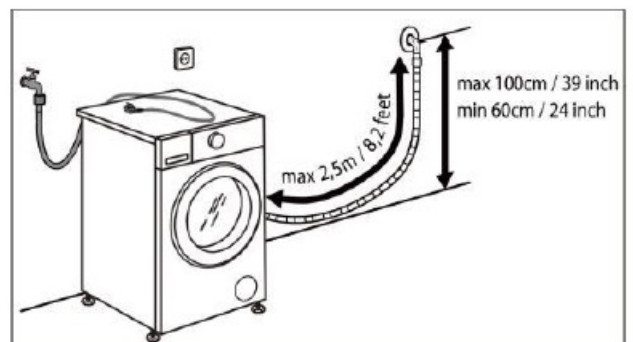

- The electrical components must not be accessible to the user after installation.
- Do not connect the machine to electrical outlets while your hands are wet or damp.
- Do not operate this appliance if it has a damaged power cord or plug, if it is not working properly or if it has been damaged or dropped.



**WARNING!** The company denies all liability if and when these norms are not respected.

### Preparing the laundry

**Please Note:** Objects such as coins, needles, nails and screws etc may cause damage to the appliance as well as your laundry. Therefore, note the following tips when preparing your laundry:

- Remove any loose items or metal objects, such as coins, needles, nails etc. from the laundry.
- Brush sand etc out of pockets and cuffs.
- Close zips and button up cushion covers, duvet covers etc.
- Remove curtain runners or secure them in a net bag.
- Delicate items such as tights, lace, socks or handkerchiefs should only be washed in a net bag or pillowcase.
- Some items are best turned inside out. These include knitwear, trousers, t-shirts and sweatshirts.

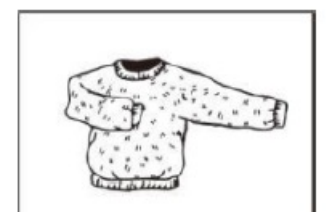
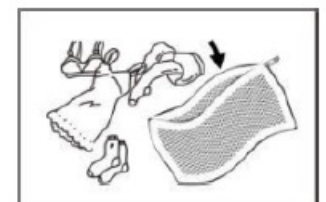
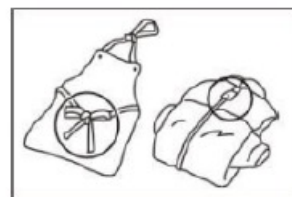
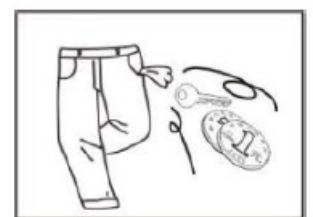

Make sure that the wire-cup bras are machine washable.

Make sure that wire-cup bras are placed in a pillow case which can be securely closed with a zip or button. If the wire works itself out the cup it may fall through the holes of the drum and cause extensive damage.

### Sorting the laundry according to colour and degree of soiling

Sort laundry items according to colour, degree of soiling and recommended wash temperature range.

- Items of clothing can become discoloured.
- Never wash new multi-coloured items together with other items.
- Wash white items separately from coloured items. Otherwise, white items may tend to become grey.

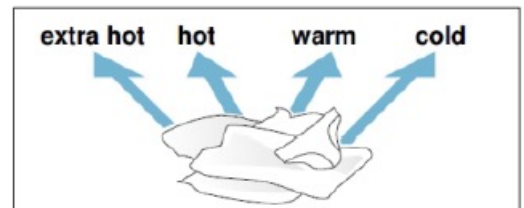
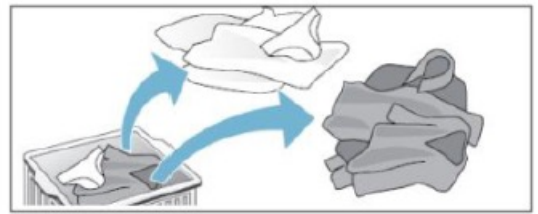

### Degree of soiling

- **Light soiling** – No visible soiling or stains but may have absorbed some odour. This could include light weight summer clothes such as t-shirts, shirts or blouses worn only once. Also to refresh bed linen and guest towels.
- **Normal soiling** – Visible soiling and/or a few light stains. This could include clothing such as t-shirts, shirts or blouses that have been sweated in or worn several times. Also, tea towels, hand towels or bed linen used for up to one week or more. Curtains without stains that have not been washed for up to half a year.
- **Heavy soiling** - Visible soiling and stains. This could include kitchen towels, fabric napkins, baby bibs, children’s outer clothing or football jerseys and shirts stained with grass or dirt. It could also include work clothes such as overalls and jeans and other clothing worn for outdoor work and activities.

## Sorting laundry according to their care label specifications

The symbols on the labels of your garments will help you in choosing the suitable wash program, the right temperature, wash cycles and ironing methods. Don't forget to give a glance to these useful indicators!

						
Wash type	Machine wash, normal/cotton	Machine wash, permanent press	Machine wash, delicate/gentle	Hand wash only	Do not wash	Do not wring
						
Water Temp.	Water temperature 30°C	Water temperature 40°C	Water temperature 50°C	Water temperature 60°C	Water temperature 70°C	Water temperature 95°C
						
Bleach	Any bleach	Non chlorine bleach	Chlorine bleach	Do not bleach		
						
Tumble Dry type	Normal/Cotton Heavy duty	Permanent Press/Wrinkle resistant	Delicate/Gentle	Do not tumble dry		
						
Tumble dry temp.	High heat	Medium heat	Low heat	No heat		
						
Dry type	Hang to dry	Drip dry	Dry flat	Dry in the shade		
						
Iron	High heat	Medium heat	Low heat	Do not Iron		
						
Dryclean	Any solvent	Perchloroethylene solvent	Petroleum solvent	Do not dryclean		



# CYCLES AND FUNCTIONS

Table of wash cycle

Wash Cycle	Temp°C (Max)	Max Load (kg)	Description	Universal Detergent	Special Detergent	Softener
Mix	60	10	For blended fabrics, e.g. cotton, linen and synthetic fibres.	L / P	---	O
Cotton	60	10	For daily items of cotton, linen and cotton blends.	L / P	---	O
Anti-allergy	85	3	For clothes that need to remove mites and allergens.	L / P	---	O
Wool	40	1	For machine washable wool and wool blend clothes.	---	L / P	O
Baby care	85	5	A cycle designed for dirt typical of children's garments in that it effectively removes any traces of residual detergent.	L / P	L	O
Shirts	60	3	For shirts and women's blouses.	L / P	L	O
Bedding	60	6	For large items such as blankets, curtains and bedspreads.	L / P	---	O
Eco 40-60	40	10	Energy efficiency test program.	L / P	---	O
20°C	30	2	For small amounts of clothes that are easy to fade.	L / P	---	O
Quick wash	40	1	For small amount or lightly soiled garments.	L / P	---	O
Underwear	60	5	For underwear.	L / P	L	O
Down wear	40	2	For down wear which can be washed by machine.	---	L / P	O
Rinse + spin	---	10	Combines a rinse and spin for loads requiring an additional rinse cycle. Also use for loads that require rinsing only.	---	---	O
Spin	---	10	This cycle uses a spin to shorten drying times for heavy fabrics or special-care items washed by hand.	---	---	---
Drum clean	85	---	Clean the drum by removing dirt and bacteria from the drum. Make sure the drum is empty.	---	---	---
One touch	40	5	Special cycle which can be started simply by pressing the ONE-TOUCH button.	L / P	---	O

## Key:

L= Gel/liquid detergent

P= Powder detergent

O= Optional

--- = No

- If using liquid detergent, it is not recommended to activate the time delay.
- Please follow the dosage recommendations on the powder or liquid detergent packaging.
- We recommended using:
  - Laundry powder 20-80°C
  - Wool detergent 20-40°C

## Various cycles

### ONE TOUCH wash cycle

**ONE TOUCH** wash cycle can intelligently detect the weight of laundry and match different washing time and temperature to realize intelligent washing. “Auto” is displayed in the detection stage after the cycle is started, and the **ONE TOUCH** wash cycle can be entered by the following three methods.

- When the washer is **OFF**, press and hold the **ONE TOUCH** button for at least 3 seconds, the washer will run the **ONE TOUCH** wash cycle directly, with the **ONE TOUCH** indicator light illuminated.
- When the washer is **ON**, press and hold the **ONE TOUCH** button for at least 3 seconds, the washer will run the **ONE TOUCH** wash cycle directly, with the **ONE TOUCH** indicator light illuminated.
- When the water is **ON**, short press the **ONE TOUCH** button, the **ONE TOUCH** indicator light will illuminate, then press the **START/PAUSE** button, the washer will then run the **ONE TOUCH** wash cycle.

### Special wash cycles

**Baby care:** a cycle designed for dirt of children’s garments in that it effectively removes any traces of residue detergent.

**Down wear:** a cycle to wash single downs (the weight of which should not exceed 2.0kg), the cushions or clothes padded with goose down such as a puffer jacket, use this special wash cycle. We recommend that down wear items are placed in the drum with their edges folded inwards (see figure) and that no more than  $\frac{3}{4}$  of the total volume of the drum is used. To achieve the best results, we recommend that a liquid detergent is used and placed inside the detergent dispenser drawer.

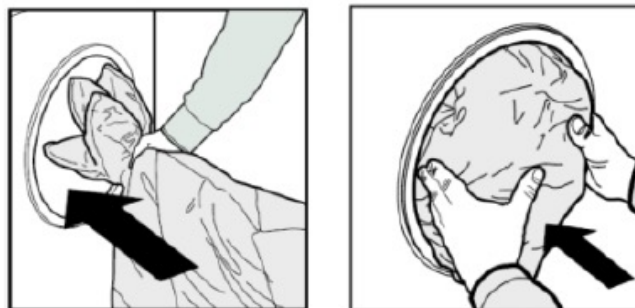

**Wool:** a cycle designed for wool fabrics.

- Before washing, please confirm that the clothes have the washing label of “machine washable”.
- After the procedure is completed, please take out the clothes quickly, shape and dry them to avoid deformation caused by being placed in the drum for too long.
- To prevent clothes from being damaged, the water temperature should not exceed 40°C.
- For best results and to reduce the damage of clothes, please use special detergent for wool and do not exceed 1.0kg of laundry.

## Various functions

### Delay end

Press the **DELAY END** button to set the program end (delay end) time in one-hour increments to a maximum of 24 hours. After selecting the desired washing program but before pressing the **START/PAUSE** button, press the **DELAY END** button until the desired time is displayed, e.g. 8h.

**Please Note:** The cycle duration is included in the set delay end time.

Here is an example of a 1hr:30 min cycle time and an 8h delay end time.

8h is displayed and count down (approximately 6hr:30mins) then the cycle duration 1:30mins is displayed and began. Total time approximately is 8 hours.

The way to cancel the delay end function is:

- Turn the wash cycle selector knob to reset the wash cycle.

### **Please Note:**

- Delay end function cannot be set on some wash cycles.
- The end time of the wash cycle may be different from the actual reservation time depending on the water supply pressure, drainage, clothing type, water temperature and other conditions.

### Child Lock

1. Setting the **child lock** function can avoid children’s mis-operation and external interference to the washing procedure.
2. During operation, long press the **SPEED** button for 3 seconds to set or cancel the **child lock** function.
3. After the **child lock** function is set, the indicator light will illuminate, the door cannot be opened, the control panel is locked and all buttons on the control panel do not respond. You can turn off the machine by turning the wash cycle selector knob.
4. After the **child lock** function is set. When the machine is turned on again, the machine directly run the program before turning off the machine.

### Canceling the buzzer

Press and hold the **SPEED** button and **ONE TOUCH** button together at the same time for at least 3 seconds, you can turn off the buzzer that sounds during the washing cycle running.

- To activate the buzzer setting – Do the same operation as you did for cancelling. The buzzer setting is activated after one beep.

## Add clothes during the program is running

When the program is running, long press the **START/PAUSE** button to pause the machine, open the door and add clothes. After the operation is completed, close the door, long press the **START/PAUSE** button again, and the machine continues to run.

**Please Note:** If the water level or water temperature in the drum is too high, the door lock indicator light is illuminated, the door cannot be opened and the midway clothes filling function cannot be used.

## Steam

A cycle designed for cotton clothes that are not easy to fade.

Steam treatment can reduce the wrinkles in clothes, make the clothes reach the ideal humidity level, reach the most relaxed state, and make ironing easier.

- Steam treatment can get rid of the peculiar smell on clothes.

## Load balancing system

The washer has an automatic detection system for eccentric load. In the process of spinning, if the clothes are unevenly distributed, the washer will level and adjust the clothes until the clothes are evenly distributed before spinning. If the clothes cannot be evenly distributed within the specified time, the washer will not spin to avoid severe vibration of the machine. At this time, you need to check whether the clothes are knotted or entangled and select the “Spin” program after reorganizing the clothes. When washing less clothes, such as a pair of jeans, a sweater, a bath towel etc., the machine may not complete the spinning process due to balance protection. Please wash the large and small clothes together as much as possible to make the clothes easier to release evenly and complete the spinning process smoothly.

**Please Note:** Due to the different types and materials of the laundry, the automatic adjustment and balance system of the washer may level and adjust the clothes for many times to prolong the spinning time. This is a normal phenomenon, not a machine failure.

# OPERATING INSTRUCTIONS

## Before loading your first load of laundry

Your new washer was tested before leaving the factory. This process involves running various wash cycles. As a result, a small amount of water may remain in the tub and drainage system. Run a **Drum Clean** cycle with no laundry to clean the system before your first load of laundry.

First add 1 to 2 tablespoons of detergent to the chamber, then run the **Drum Clean** cycle. Wait for the cycle to finish.

## Daily use

### Preparing the laundry

#### EMPTY POCKETS

- Coins, paper clips etc. could damage the load and the washing machine components.
- Tissues will break down during the wash cycle and the fragments will have to be subsequently remove by hand.

#### CLOSE ALL ZIPPERS, BUTTONS AND HOOKS. TIE ALL RIBBONS OR BELTS.

- Insert the smaller garments (e.g nylon hosiery, belts,etc.) and garments with hooks (e.g. braziers) into a fabric bag or a pillowcase with zipper. Remove any rings from curtains or else place the curtains inside a fabric bag together with the rings.

#### FABRIC TYPE/SYMBOL ON THE WASH LABEL

- Cottons, mixed fibres, easy care/synthetics, wool, hand wash items.
- Separate coloured items and white items. Wash new coloured items separate.
- Wash items of different sizes in the same wash load to improve washing efficiency and distribution of the articles in the drum.
- Wash delicate items separately; they require gentle treatment.

## How to use the washer

- 1. Load laundry** – Open the door and load the laundry. Load the articles one at a time loosely into the drum, without overfilling. Observe the load sizes given in the “Table of wash cycle”. Overloading the machine will result in unsatisfactory washing results and creased laundry.
- 2. Close door** - Make sure that no laundry gets stuck between door glass and the rubber seal. Close the door and make sure you hear it click before starting the load.
- 3. Open water tap** - Make sure that the washing machine is connected to the water mains, open the water tap.
- 4. Set the desired program** - Select the required program with **WASH CYCLE SELECTOR** knob. The duration of the wash cycle is shown on the display. The washing machine automatically displays the default temperature and spin speed settings possible for the selected program. Adjust the temperature and/or spin speed setting if needed with the relative buttons.

### Change temperature, if needed.

Press the **TEMP** button to progressively lower the temperature setting until cold wash has been set (the temperature value indicator light will go out on the display). Pressing the button again sets the highest possible setting.

### Change spin speed, if needed.

Press the **SPEED** button to progressively decrease the spinning speed until the spin cycle is turned off (the spinning speed value indicator light will go out on the display). Pressing the button again sets the highest possible setting.

**Select options, if needed.**

Press the button to select the option, the respective option indicator on the display illuminates. Press button again to cancel the option; the respective option indicator extinguishes.

If the selected option is incompatible with the program set, the incompatibility will be signed by a buzzer and the corresponding indicator light will flash.

If the selected option is incomplete with another previously set option, only the most recent selection will remain active.

**5. Add detergent** - Pull out the detergent dispenser and add detergent (and additives/softener) into the relative compartments as described below

Observe the dosing recommendations on the detergent pack. Correct dosing of detergent/additives is important, because:

- It optimizes the cleaning result.
- It avoids irritating residues of surplus detergent in your laundry.
- It saves money by avoiding waste of surplus detergent.
- It protects the washer by avoiding calcification of components.
- It respects the environmental burden.

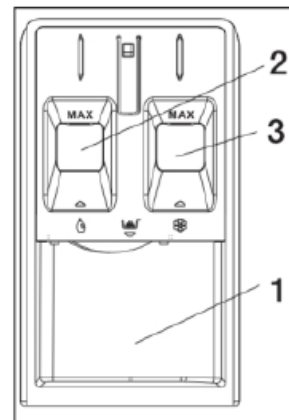

**Compartment 1:**  
**Powder washing detergent**

**Compartment 2:**  
**Liquid washing detergent**  
The liquid detergent must not exceed the "MAX" level.

**Compartment 3:**  
**Additives (Softener, etc.)** The fabric softener must not exceed the "MAX" level.



**WARNING!** Do not use hand washing detergents because these create too much foam.



**WARNING!** Use powder detergent for white cotton garments, for pre-washing, and for washing at temperatures over 60.c.



**WARNING!** Follow the instructions given on the detergent packing.

**6. Delaying the end of a program** - To set a program to end at a later time, see the section "Control panel/DELAY END".

**7. Start program** - Press the **START/PAUSE** button. The relative indicator lamp illuminates, the door locks and the **DOOR LOCK** indicator lights up.

>To avoid overflow, do not open the detergent dispenser during a running program anymore.

>The remaining program duration can vary. Factors like unbalance in the wash load, or foam formation, can have an effect on the program duration.

**8. Change the settings of a running program, if needed.**

You can still change the settings while a program is running. The changes will be applied, provided the respective program phase has not finished yet.

To change the settings of a running program:

- Press **START/PAUSE** button to put the running program on pause.
- Change your settings.
- Press **START/PAUSE** button again to continue the program.

If you have changed the program, do not add detergent for the new program.

To prevent that a running program is changed by accident (for instance by children), use the Child lock function (see section “**Control panel / SPEED**”).

### **Pause a running program and open the door, if needed.**

- Press **START/PAUSE** button to pause a running programme.
- Provided water level or temperature is not too high, the **DOOR LOCK** indicator light turns off. You can open the door, for example to add more laundry, or to remove laundry which was loaded by mistake.
- Press **START/PAUSE** button again to proceed with the program.

### **9. Cancelling a running program, if needed.**

- Turn the wash cycle selector knob to OFF position until the washer stops.
- If the water level and temperature are low enough, the door unlocks and may be opened.
- The door remains locked if there is water in the drum. To unlock the door, switch the washer on, select the **Spin** programme and turn the spin option off by pressing the **SPEED** button. Once turned off the spinning speed value indicator light will go off on the display.
- Press **START/PAUSE** button to run the **Spin** program. The water is then emptied, and the door will unlock at the end of the program.

### **10. Switch off the washer after the program ends.**

- At the end of the cycle, the message “**End**” is shown on the display.
- The door can only be opened when the symbol **DOOR LOCK** indicator turns off.
- Check that the **DOOR LOCK** indicator is off, then open the door and take out the laundry.
- Turn the wash cycle selector knob to **OFF** position to switch the washer off.

Leave the door ajar to let the interior of the washer dry.

## CLEANING & MAINTENANCE

Your washer is designed to give you years of service. Observe the following instructions to maintain and protect your washer and keep it on top operating condition.

### Risk of electrical shock hazard

- To avoid risk of electric shock always disconnect the washer from the power outlet prior to cleaning.
- Never clean the washer with a pressure washer.

### Cutting off the water and electricity supplies

- Turn off the water tap after every wash cycle. This will limit wear on the hydraulic system inside the washer and help to prevent leaks.
- Unplug the washer when cleaning it and during all maintenance work.

### Cleaning the appliance

To avoid the risk of explosions, never clean the washer with flammable solvents.

Clean the washer's exterior surface when required as follows:

- Use hot soapy water or a mild (non-abrasive) cleaning agent.
- Rub dry with a soft towel.
- Remove residue immediately.
- Do not use high pressure spray.

### Cleaning the drum

Metallic debris left in the drum can product rust spots on the drum. Never use steel wool to try to remove these. Use a chlorine-free cleaning agent and follow the manufacturer's instructions.

### Descaling the washer

Provided you use the correct amounts of detergent with you wash loads, descaling is not necessary. If descaling the washer drum does become necessary, please follow the descaling product manufacturer's instructions.

Small amounts of descaling agent can be used to remove white spots on the washer drum caused by lime or mineral deposits, or small amounts of rust caused by metal objects left in the drum.

**Please Note:** Descaling agents contain acids which may attack parts of the washer and may discolour the laundry.

### Caring for the door and drum of your appliance

- Always leave the porthole door ajar in order to prevent unpleasant odours from forming.



## Checking the water inlet hose

Check the water inlet hose at least once a year. If there are any cracks, it should be replaced immediately, during the wash cycle, water pressure is very strong and a cracked water inlet hose could easily spilt open.

Never use second-hand water inlet hose.

## Cleaning the detergent dispenser

If there is a buildup of residual detergent or additives, or if the softener compartment is not rinsed out well enough, it may be helpful to clean the dispenser.

1. Open the detergent dispenser tray fully. Press down on the drawer catch (1) and pull the tray (2) from the washer housing.
2. Remove the liquid detergent cover (3) by grasping it and pulling it upwards from the detergent dispenser tray.
3. Clean the liquid detergent cover and the detergent dispenser tray by holding it under running water. Lightly wipe away any remaining detergent residue.
4. Attach the liquid detergent cover and slide the detergent dispenser tray back in place and close the tray securely.

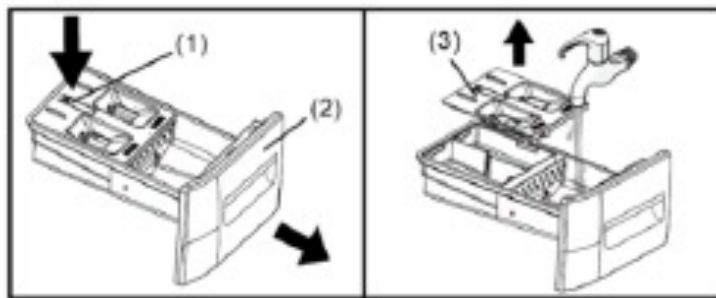

**Tip:** Do not operate the washer without the detergent dispenser tray in place. Always keep the tray completely closed.

## Cleaning the mesh filter in the water supply hose

1. Close water tap and unscrew the water inlet hose
2. Clean the mesh filter at the hose's end carefully with a fine brush.
3. Now unscrew the inlet hose on the back of the washer by hand. Pull out the mesh filter from the valve on the back of the washer with pliers and carefully clean it.
4. Insert the mesh filter again. Connect the inlet hose to the water tap and washer again. Do not use a tool to connect the inlet hose. Open the water tap and check that all connections are tight.

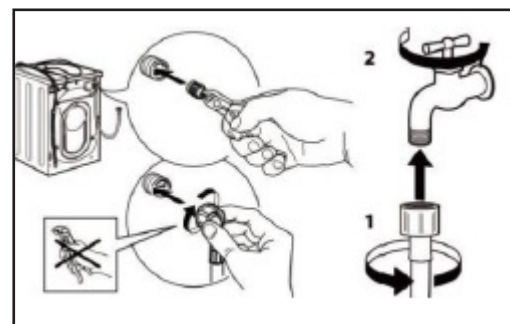
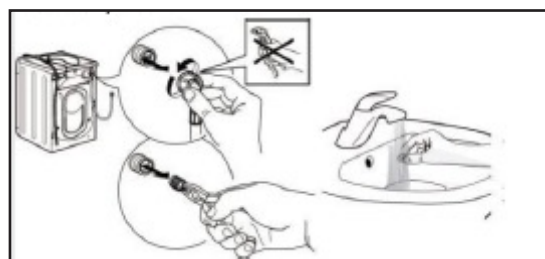
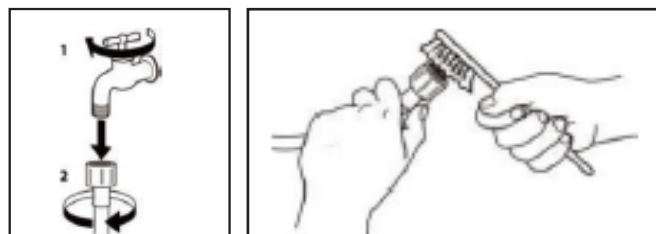

## Cleaning the drain pump



### RISK OF SCALDING

**WARNING!** Risk of hot water injury to skin!

Allow the water to cool down prior to actuating the emergency door lock release.

You are responsible for ensuring all safety precautions are followed when draining water from washer and/or manually opening the washer door.

It may be necessary to clean the washer drain pump if the washer fails to drain (sound of the water being pumped from the washer cannot be heard when the washer should be draining and other nearby drains, such as a sink, are draining properly).

The washer pump can become blocked by loose debris (a good reason to check the drum and remove any visible debris after each load). Fabrics that give off large amounts of fluff may also cause blockage.

To access the washer drain pump, the service cover must first be opened (see steps below). With the service cover opened, proceed as follows:

1. If the washer has not been drained, try to drain it now. Turn the wash cycle selector knob to the **Spin** cycle, press the **SPEED** button to set the spin cycle is turned off (all spinning speed value indicator light go out on the display), then press the **Start/Pause** button. Wait a few moments to let the cycle drain the water from the drum. If the pump is totally blocked, the water will be unable to drain and the cycle will end.



2. Shut off the tap so that no more water flows in and has to be drained. Switch the appliance off. Unplug the power plug.

3. Open the drain filter cover.

4. Use the pull-out drain hose located in the pump access opening to drain the remaining water into a suitable container (up to 5.3U.S.gallon/20 liters of water may be drained). Pull the sealing cap from the hose and lay the hose over the side of the container and allow the water to finish draining from the drum. When finished, replace the sealing cap into the end of the hose and restore the hose to its storage location.

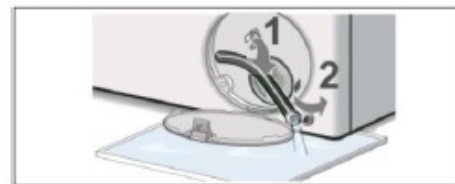

5. Turn the pump cover counterclockwise to remove it. A small amount of residual water may flow out when the cover is removed. Clean the interior of the pump hosing, removing any debris or foreign objects. Check to be sure the impeller where at the back of the pump housing can now turn freely. Remove any lint, debris or detergent residue from the threads of the pump cover and the pump cover housing. Replace the pump cover by screwing tightly into position. Handle must be vertically.

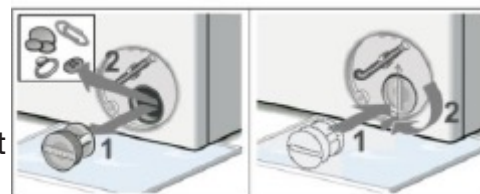

6. Close the drain filter cover. Wipe up any spilled water.



## TROUBLESHOOTING

If you are having problems with your appliance, please use our troubleshooting guide below. If you are unable to resolve the issue using this guide please ring our Customer Service Department on 01472 277 508. Please have the model code and purchase information available.

Problem	Possible Cause / Solutions
The machine does not switch on	<ul style="list-style-type: none"> <li>The appliance is not plugged into the socket fully, or not enough to make contact.</li> <li>There is not power to the socket, or the fuse has blown in the mains plug.</li> </ul>
The wash cycle does not start	<ul style="list-style-type: none"> <li>The door is not closed properly.</li> <li>The <b>ON/OFF</b> button has not been pressed.</li> <li>The <b>START/PAUSE</b> button has not been pressed.</li> <li>The water tap has not been turned on to allow water to flow into the washer.</li> <li>A delayed start has been set.</li> </ul>
The machine does not fill with water or “E02” in the display	<ul style="list-style-type: none"> <li>The water inlet hose is kinked.</li> <li>The water inlet hose is not connected to the water supply.</li> <li>The water pressure is too low.</li> <li>The water tap has not been turned on to allow water to flow into the machine.</li> <li>There is no water supply to the house.</li> <li>The inlet valve filter is blocked.</li> <li>The <b>START/PAUSE</b> button has not been pressed.</li> </ul>
The machine continuously fills with water and continually drains away or Water left in the drum or stuck on wash	<ul style="list-style-type: none"> <li>The top of the drain hose is too low - It must be fitted at a height between 65 and 100cm from the floor (see “Installation”).</li> <li>The drain hose is connected incorrectly to the sink trap allowing water to run into the machine, the drain hose must be positioned higher than the bottom of the sink to prevent water flowing down the drain hose.</li> <li>The end of the drain hose has been pushed too far down the standpipe, the “U” bracket should be fitted 100mm from the end of the drain hose.</li> </ul>
The machine does not drain or spin or “E03” in the display	<ul style="list-style-type: none"> <li>The pump filter is blocked.</li> <li>The drain hose is kinked (see “Installation”).</li> <li>New installation – The blanking cap or spigot has not been removed if connected under a sink.</li> <li>The drain hose or sink trap is blocked.</li> </ul>
The machine does not spin	<ul style="list-style-type: none"> <li>The spin cycle is turned off (all spinning speed value indicator lights will go out on the display).</li> </ul>
The program takes too long	<ul style="list-style-type: none"> <li>Program times will vary due to water pressure, the incoming water temperature and if the wash load goes out of balance. This will increase the program times accordingly (see “The machine wont spin properly” next page).</li> </ul>
The machine vibrates a lot during the spin cycle	<ul style="list-style-type: none"> <li>The feet have not been adjusted, enabling the machine to rock.</li> <li>New installation – Either the transit bolts including the plastic spacer, or the polystyrene packaging have not been removed when installing the machine.</li> <li>The washer is trapped between cabinets and/or walls.</li> <li>The load is in a slight out of balance condition and the washer is spinning, but at a lower speed.</li> </ul>
ONE TOUCH wash cycle does not activate	<ul style="list-style-type: none"> <li>After switching on the washer, a cycle other than <b>ONE TOUCH</b> wash cycle was activated. Switch the machine off and press the <b>ONE TOUCH</b> button.</li> </ul>
The machine is noisy	<ul style="list-style-type: none"> <li>There will always be some motor, pump and drum noise during spin.</li> </ul>
The machine wont spin properly	<ul style="list-style-type: none"> <li>Out of balance detected when attempting to go into a spin cycle – If this happens the washer will continue to try to repeat the distribution of the load required before the machine will go into higher spin speeds – This will increase the program time accordingly. This is a safety feature to prevent damage. Out of balance can be caused by washing a single heavy item (e.g duvet quilt etc) – Try the programme again using a different load.</li> </ul>

Problem	Possible Cause / Solutions
The machine leaks from the dispenser	<ul style="list-style-type: none"> <li>The dispenser drawer is blocked with detergent and requires cleaning.</li> <li>The water pressure is too high and requires turning down – turn down the tap on the water supply pipe slightly and try again.</li> <li>The washer is tilting forwards – It must be level when in its final position.</li> </ul>
The machine leaks (other than dispenser)	<ul style="list-style-type: none"> <li>The inlet hose is loose, check both the cabinet and tap ends.</li> <li>The inlet hose is tight but still leaks, if so replace the rubber washers, or the inlet hose is missing the rubber washer.</li> <li>The drain hose is not fixed in properly.</li> </ul>
The machine smells	<ul style="list-style-type: none"> <li>The washer requires a service wash. Run a “Drum Clean” wash cycle with detergent and no laundry.</li> </ul>
The machine door cannot be opened	<ul style="list-style-type: none"> <li>The door will not open until the door lock indicator light goes out shortly after the program has finished.</li> </ul>
The water level is too low when the machine is washing	<ul style="list-style-type: none"> <li>The water level is correct if it can be seen at the bottom of the door.</li> </ul>
There is too much foam	<ul style="list-style-type: none"> <li>The detergent is not suitable for machine washing (it should display the text “for washing machines” or “hand and machine wash”).</li> <li>Too much detergent was used – less detergent is required in soft water.</li> </ul>
General	<ul style="list-style-type: none"> <li>Your washer contains sensors that monitor progress during the wash cycle (e.g water level, temperature, out of balance loads, wash time/progress). Normally, if your washer successfully completes the cycle, there is unlikely to be anything wrong.</li> </ul>

In case of the following faults, the fault state will be detected by the microcomputer system, with the buzzer sounds issued and the following fault codes display:

Fault codes	Fault type	Possible cause / solutions
<b>E02</b>	No inlet water	<ul style="list-style-type: none"> <li>Check whether the faucet is turned on? Whether the water supply is cut off? Whether the water inlet hose and the filter of the water inlet valve are blocked? and whether the water inlet hose of the washing machine is frozen? In such case, please contact the service center for repair.</li> </ul>
<b>E03</b>	Abnormal water drainage	<ul style="list-style-type: none"> <li>Clean the pump filter.</li> <li>Check whether the drain hose is bent, twisted or blocked? If the fault still exists, please contact the service center for repair.</li> </ul>
<b>U4</b>	Door lock malfunction	<ul style="list-style-type: none"> <li>Close the door again, and then press the <b>START/PAUSE</b> button to restart the program. If the fault still exists, please contact the service center for repair.</li> </ul>
<b>H</b>	The temperature in the drum is high	<ul style="list-style-type: none"> <li>Press the <b>START/PAUSE</b> button to suspend the washing machine operation and wait for several minutes. When the temperature in the drum drops to a safe range and the fault code on the display is removed, press the <b>START/PAUSE</b> button to continue the rest of the program.</li> </ul>
<b>EXX</b>	Other faults	<ul style="list-style-type: none"> <li>Turn the washing cycle selector knob to the “<b>OFF</b>” position to turn off the power supply, unplug the power cord, and contact the service center for repair as soon as possible.</li> </ul>

**Please Note:** Be sure to check the fault cause and eliminate the fault before pressing the **START/PAUSE** button again. If the fault code is removed, the washer will continue to run, and if the fault code still exists, please unplug the power cord and call our customer service center for help as soon as possible.

**Remember, you will be charged for a service call for problems caused by incorrect installation, as indicated on pages 6 to 12. Not emptying contents from pockets may cause pump or drain hose blockages, or may damage the machine. Do not wash items which do not have a wash label, or wash items that are not intended as machine washable.**

# PRODUCT FICHE

Parameter	Value		Parameter	Value	
Rated capacity (kg)	Rated capacity <sup>(a)</sup>	5.0	Dimensions in cm	Height	85
	Rated washing capacity <sup>(a)</sup>	8.0		Width	60
				Depth	52
Energy efficiency index	EEL <sub>W</sub> <sup>(a)</sup>	51.9	Energy efficiency class	EEL <sub>W</sub> <sup>(a)</sup>	A <sup>(a)</sup>
	EEL <sub>WD</sub> <sup>(b)</sup>	66.2		EEL <sub>WD</sub> <sup>(b)</sup>	D <sup>(b)</sup>
Washing efficiency index	I <sub>W</sub> <sup>(a)</sup>	1,031	Rinsing effectiveness (g/kg dry textile)	I <sub>R</sub> <sup>(a)</sup>	5,0
	J <sub>W</sub> <sup>(b)</sup>	1,031		J <sub>R</sub> <sup>(b)</sup>	5,0
Energy consumption in kWh per kg per cycle, for the washing cycle of the household washer-dryer, using the eco 40-60 programme at a combination of full and partial loads. Actual energy consumption will depend on how the appliance is used.	0.472		Energy consumption in kWh per kg per cycle, for the wash and dry cycle of the household washer-dryer at a combination of full and half loads. Actual energy consumption will depend on how the appliance is used.	2.631	
Water consumption in litre per cycle, for the eco 40-60 programme at a combination of full and partial loads. Actual water consumption will depend on how the appliance is used and on the hardness of the water	47		Water consumption in litre per cycle, for the wash and dry cycle of the household washer-dryer at a combination of full and half loads. Actual water consumption will depend on how the appliance is used and on the hardness of the water	78	
Maximum temperature inside the treated textile (°C) for the washing cycle of the household washer-dryer, using the eco 40-60 programme	Rated capacity	35	Maximum temperature inside the treated textile (°C) for the washing cycle of the household washer-dryer, using the wash and dry cycle	Rated capacity	25
	Half	25		Half	20
	Quarter	20			
Spin Speed (rpm) <sup>(a)</sup>	Rated capacity	1400	Weighted remaining moisture content (%) <sup>(b)</sup>	62	
	Half	1400			
	Quarter	1400			
Eco 40-60 programme duration (h:min)	Rated capacity	3:38	Spin-drying efficiency class <sup>(c)</sup>	C <sup>(c)</sup>	
	Half	2:47			
	Quarter	2:47			
Airborne acoustical noise emissions during the spinning phase for the eco 40-60 washing cycle at rated washing capacity	76		Wash and dry cycle duration	Rated capacity	7:00
				Half	5:00
Type	free-standing		Airborne acoustical noise emission class for the spinning phase for the eco 40-60 programme at rated washing	B <sup>(d)</sup>	
Off-Mode (W)	0.50		Standby Mode (W)	0,50	
Delay Start (W) (if applicable)	4.00		Networked standby (W) (if applicable)	-	
Minimum duration of the guarantee offered by the supplier <sup>(e)</sup>			6 months		
This product has been designed to release silver ions during the washing cycle			NO		
Additional information:					
Weblink to the supplier's website, where the information in point 9 of Annex II to Regulation (EU) 2019/2023 is found <sup>(f)</sup> :					
<sup>(a)</sup> this item shall not be considered relevant for the purposes of Article 2(6) of Regulation (EU)2017/1369 <sup>(b)</sup> for the eco 40-60 programme <sup>(c)</sup> for the wash and dry cycle <sup>(d)</sup> changes to these items shall not be considered relevant for the purposes of paragraph 4 of Article 4 of Regulation (EU) 2017/1369 <sup>(e)</sup> if the product database automatically generates the definitive content of this cell the supplier shall not enter these data					

## Additional Information:

The above test data was obtained by washing with ECO 40-60 program.

Entry method for new standard energy efficiency (EN60456:2016 + FprAA:2020)

ECO 40-60 (Parameters are not adjusted by default)

Entry method for new standard energy efficiency (EN60456:2016 + FprAA:2020)

ECO 40-60, (Parameters are not adjusted by default)

<b>10 kg BLDC</b>	<b>20°C</b>	<b>Cotton</b>	<b>Wool</b>	<b>Quick wash</b>
<b>Rated capacity / kg</b>	2	10	1	1
<b>Program duration (h:min)</b>	0:39	0:57	0:50	0:15
<b>Energy consumption (Kwh/cycle)</b>	0.29	1.25	0.20	0.10
<b>Water consumption (L/cycle)</b>	65	80	70	40
<b>Max temperature / °c</b>	30	55	35	35
<b>RMC</b>	75%	70%	85%	75%
<b>Spinning speed / rpm</b>	700	900	500	700

- That the ECO 40-60 program is able to clean normally soiled cotton laundry declared to be washable at 40°C or 60°C, together in the same cycle, and that this program is used to assess the compliance with the EU eco-design legislation.
- That the most efficient programs in terms of energy consumption are generally those that perform at lower temperatures and long duration.
- That noise and remaining moisture content are influenced by the spinning speed: the higher the spinning speed in the spinning phase, the higher the noise and the lower the remaining moisture content.
- The values given for programs other than the ECO 40-60 program, and the wash and dry cycle are indicative only.

## FUSE REPLACEMENT (CLASS I)

This appliance must be earthed. Remove the fuse cover with a small flat head screw driver. Take out the fuse and replace with a new fuse of the same Amp. Replace the fuse cover and push back into place.

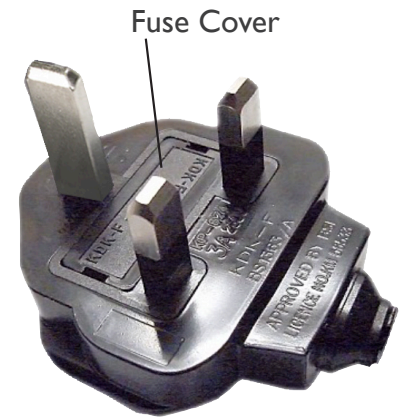

## DISPOSAL

The European Directive 2012/19/EU on Waste Electrical and Electronic Equipment (WEEE), requires that old household electrical appliances must not be disposed of in normal unsorted municipal waste.

Old appliances must be collected separately in order to optimise the recovery and recycling of the materials they contain and reduce the impact on human health and the environment.

The crossed out “wheeled bin” symbol on the product reminds you of your obligation, that when you dispose of the appliance it must be separately collected. Consumers should contact their local authority or retailer for information concerning the correct disposal of their old appliance.





## STATESMAN WARRANTY/GUARANTEE TERMS & CONDITIONS

### THANK YOU FOR CHOOSING STATESMAN

To help protect your product, we want to give you an additional 12 months warranty. If you register your appliance within 30 days of purchase, we will activate your additional 12 months warranty, giving you **24 months peace of mind**. This means that in the unlikely event you develop a fault or problem with your product we will happily repair or replace the item free of charge. To qualify for the guarantee, the product must be used for domestic household use only and in accordance with the instructions in the user manual. Any misuse of the product will result in the warranty being void. The guarantee does not cover accidental damage, misuse, neglect, tampering or incorrect adjustment or installation. The guarantee will be rendered invalid if the product is resold, has had its serial number or rating label removed (or has an invalid serial number or rating label), or if an unauthorised person has carried out any repairs or alterations.

**You can instantly activate your 24 month warranty by visiting [www.statesman.warrantyonline.co.uk](http://www.statesman.warrantyonline.co.uk). Once your registration has been processed you will receive confirmation of your warranty.**

The warranty does not cover accessories or consumable parts that require replacement under normal use. This includes shelving, dials, filters, belts and trays etc. In the unlikely event of a breakdown please refer to the Troubleshooting Guide in your user manual and check all plugs, fuses and the electricity supply. If you still require assistance, please contact our Customer Service Department on **01473 277 508** or write to us at the following address:

#### **Customer Service Department:**

**38 Bluestem Road, Ransomes Industrial Estate, Ipswich, IP3 9RR.**

Please quote the Product Code and the PO number on the rating label and give details of the exact fault. We will then decide whether to replace the item.

**IMPORTANT NOTE: Before we arrange the replacement, you will be required to return a copy of your proof of purchase. Please retain your original receipt. If an item is replaced within the agreed warranty period, the warranty for the replacement item will be calculated from the purchase date of the original.**

If the product is inspected, and no fault is found, or the product is not within the guarantee period you will be charged for the repair and any carriage costs.





# STATESMAN

---

kitchen appliances

**38 Bluestem Road, Ransomes Europark, Ipswich, IP3 9RR  
Castle Electrical Factors Ltd., Dundalk, A91 KA9R, IR**

**01473 277 508**

Disclaimer: Statesman operate a policy of continual improvement and development.  
We therefore reserve the right to change/alter the specification and appearance of our appliances without prior notice.  
All diagrams and images shown in this manual are for illustration purposes only.