

STATESMAN

kitchen appliances



THP18W 8KG HEAT PUMP TUMBLE DRYER

Instruction Manual

PO Number:

Please read these instructions carefully before use and retain for future reference. Before switching on your appliance – Always check for any damage that may have been caused in transit.

CONTENTS

Important Safety Instructions	3-4
Appliance Overview.....	5
Product Specification	6
Installation.....	7
Operating Instructions	8-14
Cleaning & Maintenance.....	15
Troubleshooting Guide.....	16
Mains Plug Fuse Replacment.....	17
Disposal Information.....	18
Statesman Warranty.....	19

IMPORTANT SAFETY INSTRUCTIONS

Read and follow all of the instructions even if you feel you are familiar with the product, and find a place to keep this manual handy for future reference.



WARNING! This product is intended for domestic use only. When using electrical appliances, basic safety precautions should always be followed:

- Do not operate the appliance with a damaged cord or plug, after it malfunctions or has been dropped or damaged in any way. All electrical repairs must be carried out by a qualified electrician.
- Check the voltage of the appliance matches the household voltage, which is located on the rating label.
- Use of an extension cord is not recommended with this product.
- Children should be supervised to ensure that they don't play with the appliance.
- Cleaning and user maintenance shall not be made by children.
- Keep the appliance and its cord out of the reach of children.
- This appliance can be used by children from 8 years of age and persons with reduced physical, sensory or mental capabilities or lack of experience and knowledge if they have been given supervision or instruction concerning use of the appliance in a safe way and understand the hazards involved.
- Children less than 3 years of age should be continuously supervised around the appliance.
- Keep all packaging well away from children as there is a risk of suffocation.
- Always unplug the appliance before attempting to move. When disconnecting from the electricity supply, pull the plug and not the cord.
- This product is for indoor use only.
- The refrigerant of this product is R290 which is flammable. Keep away from open flame and other sources of ignition.
- Make sure that the power plug is not squashed or damaged by the back of the appliance. A squashed or damaged power plug may overheat and cause a fire.



WARNING!: The appliance is heavy, and care is needed when unpacking and moving. Get extra help and only hold the appliance by the casing – never hold by the door or the trim.



WARNING!: Risk of child entrapment. Always close the door after use to avoid children or pets climbing inside or hiding things inside the dryer.



WARNING!: Risk of fire/flammable materials.

- When positioning the appliance, ensure the supply cord is not trapped or damaged.
- Do not locate multiple portable socket-outlets or portable power supplies at the rear of the appliance.

- Do not stack this dryer on a washing machine without a stacking kit.
- Do not lean on the opened door of the dryer.
- Condensed water is not suitable for drinking. It can cause health problems in both people and animals if consumed.
- Do not exceed the rated load for this appliance.
- Do not operate the dryer without the door filter.
- Do not dry clothes before being spun.
- Do not expose the dryer to direct sunlight.
- Do not install the dryer in a humid environment.
- The appliance should not be overturned during normal use or maintenance.
- Items such as foam, shower caps, waterproof materials, rubber backed items should not be dried in the tumble dryer.
- Fabric softeners or similar products should be used as specified by the fabric softener instructions.
- Remove all objects from pockets.



WARNING!: Never stop a tumble dryer before the end of the drying cycle unless all items are quickly removed and spread out so that the heat is dissipated.

- The lint trap should be cleaned regularly.
- Lint must not be allowed to build up around the dryer.
- Leave the appliance to stand for 2 hours after transporting.

APPLIANCE OVERVIEW

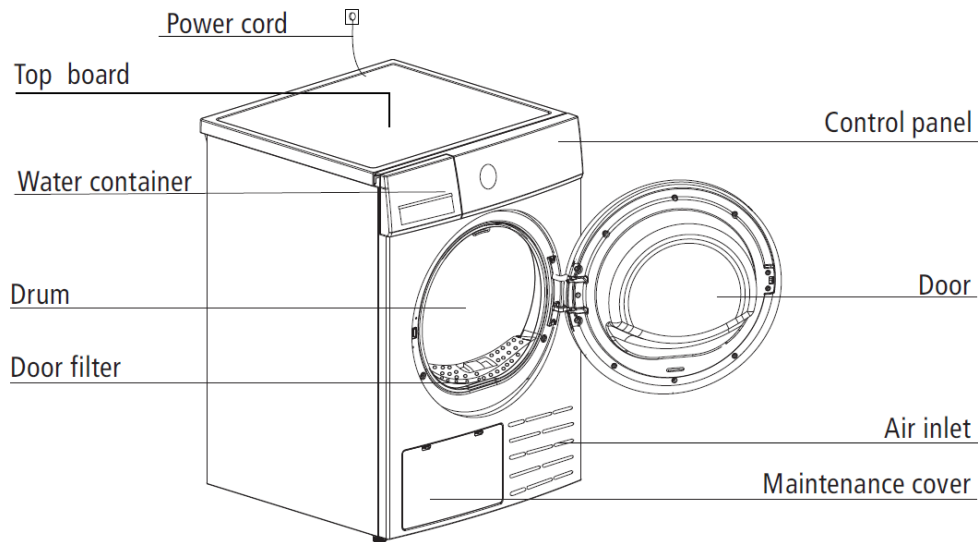

The following parts are optional for specific models. If your dryer has the following parts, please wear gloves and install them following the instruction below:

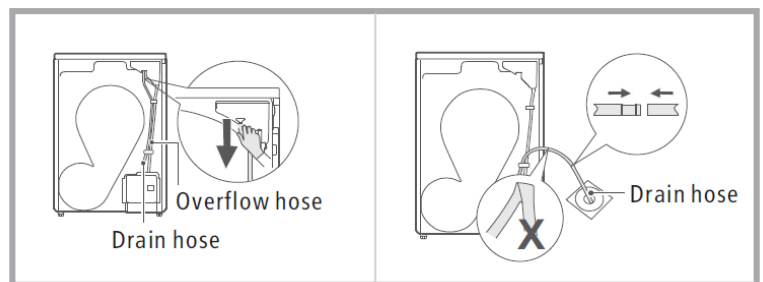
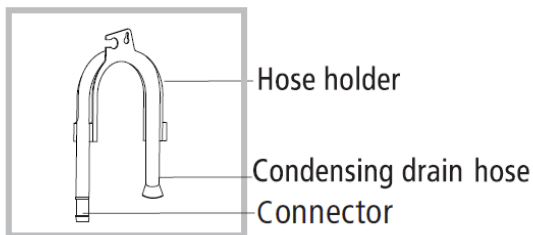

Pull out the upper drain hose.

Put the external hose into a drain (be careful not to bend the hose)

PRODUCT SPECIFICATION

Model:	THP18W
Product Dimensions (mm):	H:845 x W:595 x D:600
Product Weight:	41kg
Ambient Temperature:	+5°C ~ +35°C
Drying Capacity:	8kg
Energy Consumption:	235kWh
Noise Level:	65dB
Energy Rating:	A++
Rated Voltage:	220-240v
Rated Input Power:	800W
Rated Frequency:	50Hz
Refrigerant:	R290



WARNING!:

- The drying capacity is the maximum capacity that can be dried at one time.
- Do not install the tumble dryer in a room where there is a risk of frost. At temperatures around freezing point the tumble dryer may not be able to operate.
- There is a risk of damage if the water is allowed to freeze in the pump, hoses or water container.

INSTALLATION

- The appliance must stand vertically on a flat, even surface. It is not recommended to stand the appliance on a carpeted surface.
- Do not restrict the floor clearance, with thick carpet or other objects, as this might cause heat build which could interfere with the operation of the appliance.
- To level the appliance, use the levelling feet by turning them until the appliance is as level as possible.
- Before use, all packing materials should be removed.
- Do not expose the appliance to damp conditions, open air or rain.
- Do not place the appliance in a location where it is moist or damp.
- Do not install the dryer in a room where there is a risk of frost occurring. At temperatures around freezing point the dryer may not be able to operate correctly. There is a risk of damage if the condensed water is allowed to freeze in the pump and hoses.
- Do not lift the appliance by the door when moving.
- It is not recommended to place the appliance in a wall recess, fitted cabinet or furniture, as this will not allow adequate ventilation and could be a potential fire hazard.
- It is recommended for your convenience that the machine is positioned close to your washing machine.
- Enough space should be left to open the door.
- Do not stack this dryer on a washing machine without a stacking kit.
- The tumble dryer must be installed in a clean place, where dirt does not accumulate. Air must be able to circulate freely around the appliance. Do not obstruct the front air inlet or the air intake grills at the back of the machine.
- To keep vibration and noise to a minimum level when the dryer is in use, it must be placed on a firm and level surface.
- The feet must never be removed.

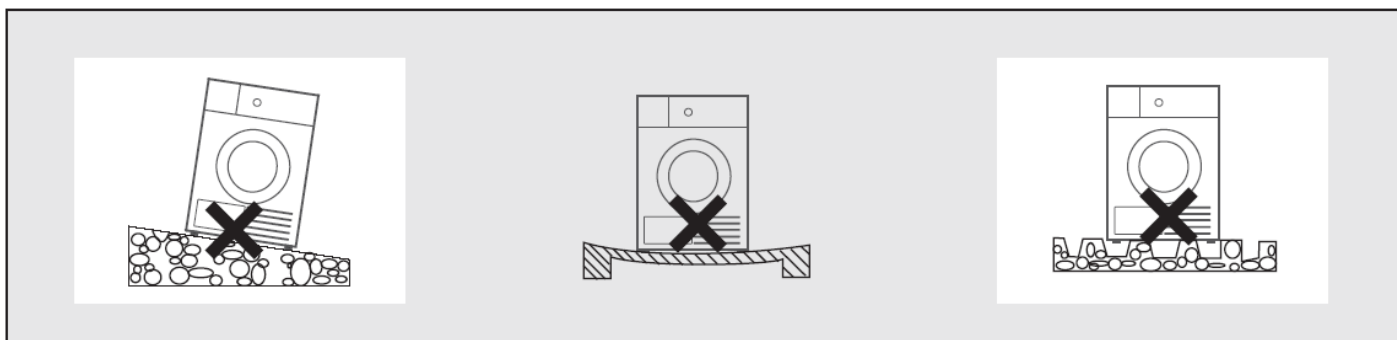

OPERATING INSTRUCTIONS

Quick Start Guide

Before Drying:

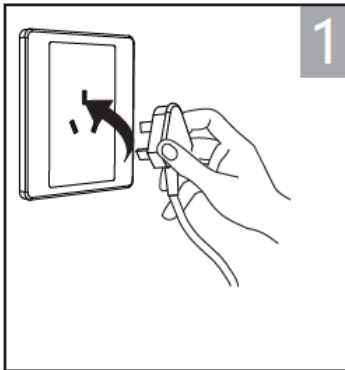

Plug in.

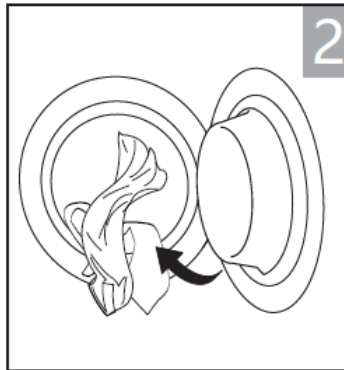

Load.

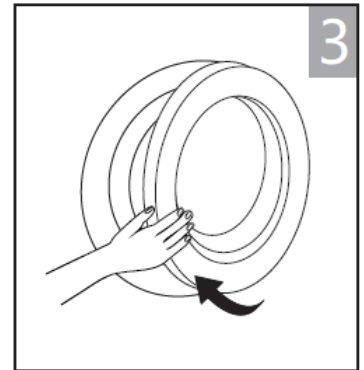

Close the door.

Drying:



On



Select Programme



Select Function/Default



Start

After Drying:

Buzzer will sound and “End” will display.

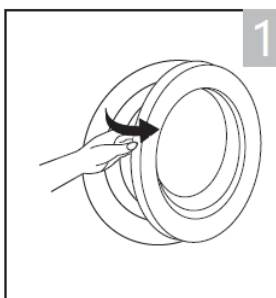

Open the door and take out laundry.

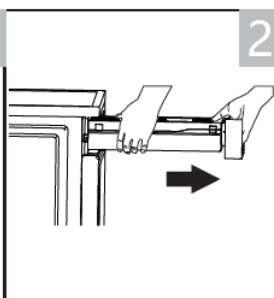

Pull out the container.

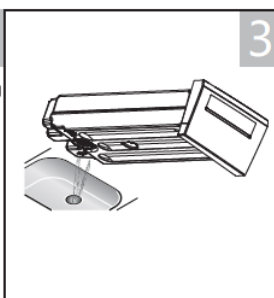

Pour out the water that has condensed.

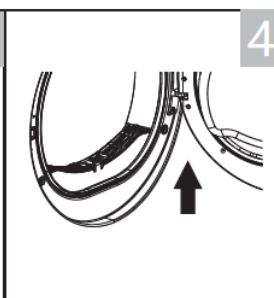



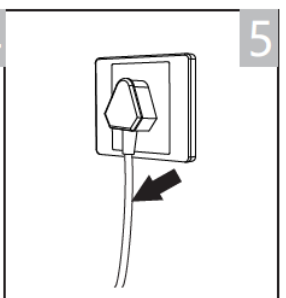







Clean the filter.



Power off.





- Before first use, take a soft cloth and clean the inside of the drum.
- Put some clean cloths inside the drum.
- Press On/Off.
- Select the Refresh Programme, press Start/Pause.
- After finishing this programme, please follow the “Cleaning & Maintenance” section to clean the door filter.
- During drying, the compressor and the water will generate some noise which is entirely normal.
- Before drying, thoroughly spin the laundry in the washing machine. High spin speed shortens the drying time and saves energy.
- For better drying results, sort the laundry according to fabric type and select the appropriate drying programme.
- Before drying, please close zips, hooks, buttons, tie fabric belts etc.
- Remove all objects from pockets.
- Close duvet covers to prevent smaller items from being rolled up inside.
- Leave jackets open and undo long zips so that items can dry evenly.
- Do not over dry the clothes as they can become creased.
- Do not dry items containing rubber or similar elastic materials.
- The door should only be opened after the programme is finished to avoid being scalded by hot steam.
- Clean the filter and empty water container after each use to avoid extension of drying time and increase of energy consumption.
- Do not dry clothes after dry clean process.

Weight of Dry Clothes (Weight per item):

 Sweater (mixed 800g)	 Jacket (cotton 800g)	 Jeans (800g)	 Bath Towel (cotton 900g)
 Single bedsheet (cotton 600g)	 Work clothes (1120g)	 Pyjamas (200g)	 Shirt (cotton 300g)
 T-Shirt (cotton 180g)	 Underwear (cotton 70g)	 Socks (mixed-weave 50g)	

- Do not load more than rated.
- Do not dry dripping wet laundry.

Only dry laundry suitable for tumble drying. Please see below for laundry care labels:

-  Suitable for tumble drying
-  Normal temperature drying process: Drying in the tumble dryer is possible under normal load and temperature 80°.
-  Low temperature drying process: Caution is needed when tumble drying. Select low temperature.
-  Do not tumble dry items unsuitable for drying in the tumble dryer.

Control Panel

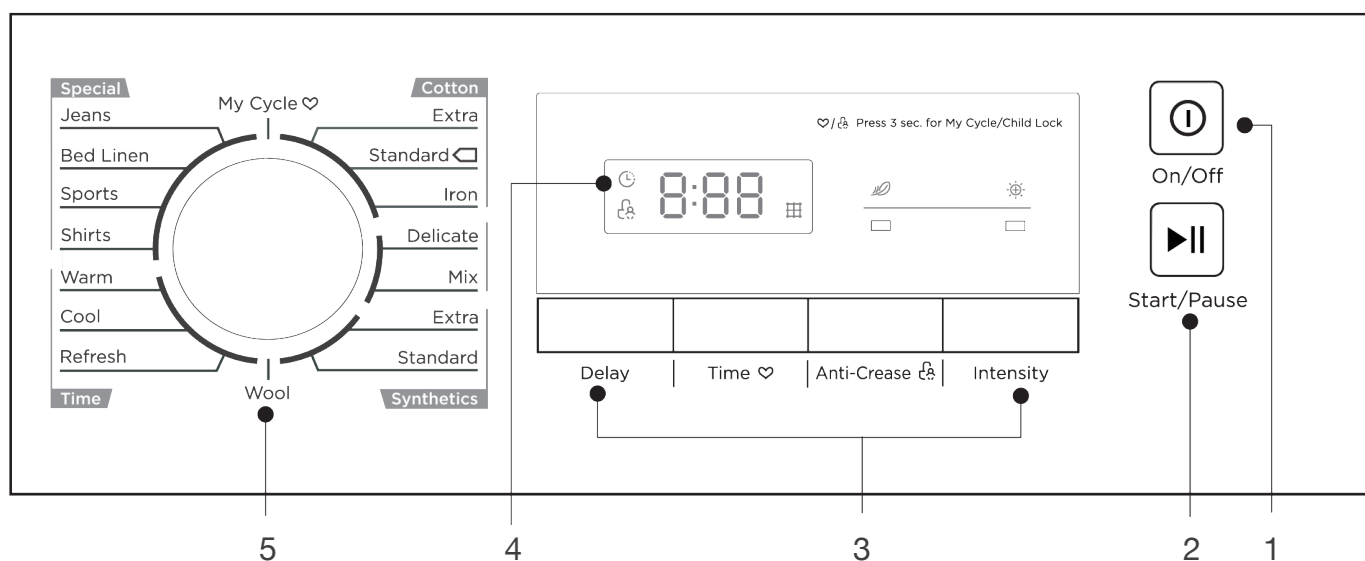

1 - On/Off	Product is switched on or off.
2 - Start/Pause	Press the button to start or pause the drying cycle.
3 - Options	These buttons are used for setting additional functions.
4 - Display	This display shows the setting, estimated programme time remaining and status messages of your dryer.
5 - Programmes	Different drying cycles can be selected according to the users need and the type of laundry to be dried.

Options

Delay

Delay

This function is used for delaying the start of the drying programme for up to 24 hours. When the delayed programme starts, the time starts to countdown on the display and the delay icon flashes.

1. Load your laundry and make sure the machine door is closed.
2. Press the [On/Off] button, then turn the programme dial to select the desired programme.
3. You can additionally select the [Anti-Crease] function according to your need.
4. Press the [Delay] button.
5. Continue to press [Delay] to select the desired delay time.
6. After the [Start/Pause] button is pushed, the dryer is ready to run a cycle. The drying cycle will begin automatically once the delay time has passed.
7. If you push the [Start/Pause] button again, the delay function will be paused.
8. If you want to cancel the "Delay" function, please press the [On/Off] button.

Time

Time

When the [Warm] or [Cool] or [Refresh] programme is selected, the [Time] button can be used to adjust the drying time in 10 min. steps.

Intensity

Intensity

You can adjust the dryness level of the laundry by pressing the [Intensity] button.

1. The intensity function can be activated only before the programme start.
2. The [Intensity] function can be used with all programmes except [Cotton Iron], [Warm], [Cool], [Refresh], [Wool] and [Delicate].

Anti-Crease

Anti-Crease

At the end of the drying cycle, the anti-crease time is 30 minutes (default) or 120 minutes (selected).

The [Anti-Crease] light will illuminate when the anti-crease function is selected. This function prevents the laundry from creasing. The laundry can be removed during the anti-crease phase. All programmes provide this function except [Cool], [Refresh] and [Wool]

My Cycle

My Cycle

Use [My Cycle] to set and save your favourite or most-frequently used programme for ease of use.

1. Select the desired programme and other drying functions.
2. Press and hold the [Time] button for 3 seconds until the beep sounds and the desired programme has been saved.
3. Turn the programme dial to the [My Cycle] position, then you can start your preferred programme.





If you want to change the [My Cycle] settings, repeat steps 1 and 2.



Child Lock

Child Lock

1. This machine incorporates a special child safety lock, which can prevent children from accidentally pressing buttons or interfering with the functionality of the dryer.
2. When the drying cycle is running, press the [Anti-Crease] button for 3 seconds to activate the child lock function.
3. When child lock function is set, the display will show the child lock icon and all buttons are deactivated, except [On/Off] button.
4. To deactivate the child lock function, press the [Anti-Crease] button again for 3 seconds.

Display

	Delay
	Child Lock
	Anti-Crease
	My Cycle

	Remaining Time Indicator / Error Message
	Clean Filter (Warning)
	Intensity

Programme Selector

1. When the LED display screen brightens up, rotate the programme dial to select the desired programme.
2. Select the [Delay], [Time], [Intensity], or [Anti-Crease] functions for additional options.
3. Press the [Start/Pause] button.
4. Press the [On/Off] button after the programme has completed.

Programme Start

The drum will rotate after the programme starts. The remaining programme time will be displayed.

Programme End

1. The drum will stop rotating after the programme ends. The display will show “End”. The dryer will automatically start the [Anti-Crease] function if the user doesn’t remove the load.
(Refer to page 11).
Please press [On/Off] button after unloading the tumble dryer to cut off power and then either switch off at the socket or remove the plug from the wall.
2. Any problems that occur should be dealt with using the trouble shooting section (page 16).

NOTE: During drying, water may collect between the window and the seal. This does not affect the function of your dryer.

Drying Programmes Table

Programme		Max Load	Application/Properties	Delay	Time
Cotton	Extra	8.0kg	For single or multi-layer cotton laundry to be dried completely for direct storage.	Y	N
	Standard <input type="checkbox"/>				
	Iron		For single layer cotton laundry to remain damp for ironing.		
Delicate		1.0kg	For delicate laundry that is suitable for drying or laundry advised to be hand washed at low temperatures.	Y	Y
Mix		3.5kg	For mixed fabrics from cotton and synthetics.	Y	N
Synthetics	Extra	3.5kg	For thick or multi-layer synthetic fabrics to be dried completely.	Y	N
	Standard		To dry thin synthetic textiles, which are not ironed, such as easy care shirts, baby clothes or socks.		
Wool		1.0kg	For machine washable wool items.	Y	N
Special	Jeans	4.0kg	To dry jeans or leisure clothes that are spun at high speed in the washing machine.	Y	N
	Bed Linen	4.0kg	To dry bed linen, bed sheets or other large items.		
	Sports	3.0kg	To dry sportswear and thin fabrics from polyester, which are not ironed.		
	Shirts	1.0kg	For easy care laundry, such as shirts and blouses equipped with anti-crease functionality to minimize the ironing effort. Place clothes loosely in the dryer. Once dried, remove quickly and hang on a clothes hanger.		
My Cycle		-	Define and save your favourite programme	Y	-
Time	Warm	-	To dry individual items or complete the drying process of multi-layer fabrics with different drying behavior, such as jackets, pillows or voluminous items. Min 10 min. to max. 120 min. (in 10 min.steps)	Y	Y
	Cool	-	To air items without heating. Min. 10 min to max. 30 min.(in 10 min. steps)		
	Refresh	1.0kg	To refresh clothes kept in a closed environment for a long time or to remove odors. Min. 20 min to max. 220 min.(in 10 min. steps)		

Test programme in accordance with Regulation 392/2012/EU for energy labelling, measured in accordance with EN 61121 and suitable for drying normal cotton load at rated load capacity.

Thick or multi-layered fabrics, e.g. bedlinen, jeans, jackets etc, are not easy to dry. You'd better choose Cotton Extra programme.

As the uneven material, thick and multi-layered clothes are not easy to dry, it is better to choose the appropriate time drying programme to dry them if some parts of the clothes still damp after programme finished.

Consumption Data

Model	Programme	Capacity	Spin Speed / Residual Humidity	Drying Time	Energy Consumption
MDG80-CH05/B05E-EU(A2)-P2	Cotton Standard	8kg	1000rpm / 60%	210min	1.90kWh
	Cotton Standard	4.0kg	1000rpm / 60%	125min	1.10kWh
	Synthetic Standard	3.5kg	800rpm / 40%	60min	0.60kWh

CLEANING & MAINTENANCE

Empty the Water Container

- Pull out and hold the water container with two hands.
- Tilt the water container and pour out the water into a drain or sink.
- Replace the water container.



WARNING! Empty the water container after each use. Once the water container is filled completely, the programme will be paused and the “Full” icon will light. After the container is emptied, the dryer can be restarted by pressing [Start/Pause] button.

- Do not drink the condensated water.
- Do not use the dryer without the water container.

Cleaning the Door Filter

This appliance has a door lint filter. Ensure the filter is cleaned after each cycle. To ensure the double layer filter can be closed, the arrows at both ends need to be aligned.

- Open the door.
- Take out the door filter.
- Open the filter and remove the fluff on the filter, the filter can be cleaned under running water.
- Dry the filter thoroughly before installing back in the door.

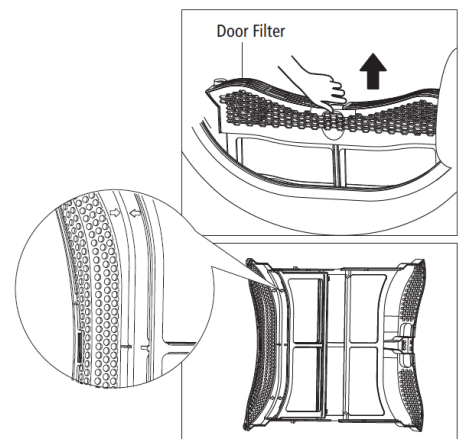

Cleaning the Heat Exchanger

WARNING:

- Do not touch the heat exchanger with your hand, this may cause injury.
- As necessary, approximately once every 3 months, remove fluff from the heat exchanger using a vacuum cleaner with a dusting brush attachment.
- Clean the heat exchanger without applying any pressure. Otherwise, the heat exchanger could be damaged. The dryer will not dry if the cooling fins are damaged or bent.

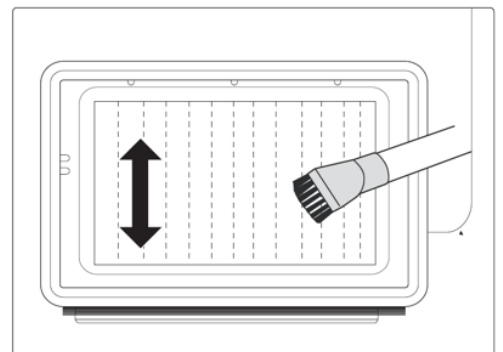

Cleaning the Tumble Dryer

WARNING:

- Disconnect the power cord before cleaning.
- Do not use solvents, abrasive cleaners, glass cleaners or all-purpose cleaners. These could damage plastic surfaces and other parts.
- Use a damp cloth.
- Clean the door and window.
- Clean the seal around the door opening.
- Clean the humidity sensor inside the drum.
- Take out all the filters, clean the seal and air flow openings.
- Before starting the dryer, dry all parts with a soft cloth.

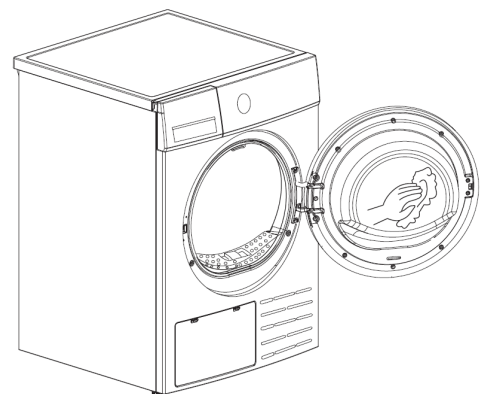

TROUBLE SHOOTING GUIDE

If you are having problems with your appliance, please use our trouble shooting guide below. If you are unable to resolve the issue using this guide, please ring our Customer Service Department on 0844 848 5861. Please have the model code and purchase information available.

Problem	Solution
Display is not on	<ul style="list-style-type: none"> • Check if the power supply works. • Check if the mains plug is inserted. • Check the selected programme. • Press the [On/Off] button.
“FULL” is showing on display	<ul style="list-style-type: none"> • Empty water container. • If the light still remains on, please call customer service.
“  ” is showing on display	<ul style="list-style-type: none"> • Clean the lint filter
Dryer does not start	<ul style="list-style-type: none"> • Connect the tumble dryer to the mains. • Turn on the tumble dryer. • Check the door is closed. • Check the programme is set. • Press the [Start/Pause] button.
Degree of dryness was not reached or drying time too long	<ul style="list-style-type: none"> • Clean lint filter and heat exchanger. • Empty the water container. • Check the drain hose. • Check installation place is appropriate. • Keep the air inlet clean. • Use higher drying intensity level programme or time programme.
There are humming noises	<ul style="list-style-type: none"> • The compressor is operating. These noises are quite normal and do not indicate a fault.
The dryer switches off at the end of the programme	<ul style="list-style-type: none"> • The dryer switches off automatically for energy saving. This is not an error but a normal function.

ERROR CODES

Display	Reason	Solution
“E32”	Humidity sensor error	Please contact your local service centre if the problem persists
“E33”	Temperature sensor error	
“E82”	Communication error	

MAINS PLUG FUSE REPLACEMENT

Fuse Replacement (Class I)

This appliance must be earthed. Remove the fuse cover with a small flat head screwdriver. Take out the fuse and replace with a new fuse of the same Amp. Replace the fuse cover and push back into place.



DISPOSAL INFORMATION

The European Directive 2002/96/EC on Waste Electrical and Electronic Equipment (WEEE), requires that old household electrical appliances must not be disposed of in normal unsorted municipal waste. Old appliances must be collected separately in order to optimise the recovery and recycling of the materials they contain and reduce the impact on human health and the environment. The crossed out “wheeled bin” symbol on the product reminds you of your obligation, that when you dispose of the appliance it must be separately collected. Consumers should contact their local authority or retailer for information concerning the correct disposal of their old appliance.



STATESMAN WARRANTY/GUARANTEE TERMS & CONDITIONS THANK YOU FOR CHOOSING STATESMAN

As a valued customer we would like to offer you a **FREE 2-year warranty** to cover your product against any electrical or mechanical defects. This means that in the unlikely event you develop a fault or problem with your product we will happily repair or replace the item free of charge. To qualify for the guarantee, the product must be used for domestic household use only and in accordance with the instructions in the user manual. Any misuse of the product will result in the warranty being void. The guarantee does not cover accidental damage, misuse, neglect, tampering or incorrect adjustment or installation. The guarantee will be rendered invalid if the product is resold, has had its serial number or rating label removed (or has an invalid serial number or rating label), or if an unauthorised person has carried out any repairs or alterations.

The warranty does not cover accessories or consumable parts that require replacement under normal use. This includes shelving, dials, filters, belts and trays etc. In the unlikely event of a breakdown please refer to the Troubleshooting Guide in your user manual and check all plugs, fuses and the electricity supply. If you still require assistance, please contact our Customer Service Department on **01473 277 508** or write to us at the following address:

Customer Service Department:

38 Bluestem Road, Ransomes Industrial Estate, Ipswich, IP3 9RR.

Please quote the Product Code and the PO number on the rating label and give details of the exact fault. We will then decide whether to replace the item.

**IMPORTANT NOTE: Before we arrange the replacement, you will be required to return a copy of your proof of purchase. Please retain your original.
If an item is replaced within the agreed warranty period, the warranty for the replacement item will be calculated from the purchase date of the original.**

If the product is inspected, and no fault is found, or the product is not within the guarantee period you will be charged for the repair and any carriage costs.

STATESMAN
kitchen appliances

**38 Bluestem Road, Ransomes Europark Ipswich, IP3 9RR
EU: Castle Electrical Factors Ltd., Dundalk, A91 KA9R, IR**

01473 277 508