

STATESMAN

kitchen appliances



**TNF1860WE/TNF1860XE
60CM 60/40 TOTAL NO FROST FRIDGE FREEZER
WITH LED DISPLAY**

Instruction Manual

PO Number:

**Please read these instructions carefully before use and retain for future reference.
Before switching on your appliance – always check for any damage that may have
been caused in transit.**

CONTENTS

Important Safety Instructions	3-6
Specification.....	7
Appliance Overview.....	8
Installation	9-15
Operating Instructions.....	16-22
Cleaning and Maintenance.....	23-24
Trouble Shooting Guide.....	25
Fuse Replacement	26
Disposal Information	26
Statesman Warranty Information.....	27

IMPORTANT SAFETY INSTRUCTIONS

Read and follow all of the instructions even if you feel you are familiar with the product, and find a place to keep this manual handy for future reference.

Important: This product is intended for domestic use only; to store and freeze food products only. When using electrical appliances, basic safety precautions should always be followed:

- The operating voltage of the appliance is 220-240V. Check the voltage of the appliance matches the household voltage on the rating label and specification.
- Do not operate the appliance with a damaged cord or plug, after it malfunctions or has been dropped or damaged in any way. All electrical repairs must be carried out by a qualified electrician. Inadequate repairs may result in a major source of danger for the user and invalidate the warranty.
- Use of an extension cord is not recommended with this product.
- This appliance can be used by children aged from 8 years and above if they have been given supervision or instruction concerning the use of the appliance in a safe way and understand the hazards involved.
- Children aged from 3 to 8 years are allowed to load and unload this appliance.
- Cleaning and user maintenance shall not be made by children.
- Keep the appliance and its cord out of reach of children.
- Children shall not play with the appliance.
- Keep all packaging well away from children. There is a risk of suffocation
- This appliance can be used by persons with reduced physical, sensory or mental capabilities or lack of experience and knowledge if they have been given supervision or instruction concerning use of the appliance in a safe way and understand the hazards involved.
- Always unplug the appliance before attempting to move. When disconnecting from the electricity supply, pull the plug and not the cord.
- This product is for indoor use only.
- Do not store explosive substances such as aerosol cans with a flammable propellant in this appliance.
- Always keep the ventilation openings clear of obstruction. Should they become blocked, clear them straight away.

- The refrigerant of this product is R600a which is flammable. Ensure when moving the appliance or during installation that the cooling system does not get damaged.



WARNING: Risk of child entrapment.

Before disposal of the old appliance, make sure that any locking mechanisms have been broken off, doors have been removed but shelves have been left in so that children cannot easily climb inside. Also remove the plug so the appliance is unusable.



WARNING: Do not use mechanical devices or other means to accelerate the defrosting process.



WARNING: Do not touch the light bulb if it has been on for a long period of time because it could be very hot.



WARNING: During transportation and installation of the appliance, be certain that none of the components of the refrigerant circuit become damaged.

- Make sure that the power plug is not squashed or damaged by the back of the appliance. A squashed or damaged power plug may overheat and cause a fire.
- Do not remove or touch items from the freezer compartment if your hands are damp/wet, as this could cause skin abrasions or frost/freezer burns.
- The refrigerating appliance is not intended to be used as a built-in appliance.



WARNING: The appliance is heavy and care is needed when unpacking and moving it. Get extra help and only hold the appliance by the casing – never hold by the door or the trim.



WARNING: During use, servicing and disposal of the appliance, please pay attention to this symbol which is located on rear of appliance.



There are internal flammable materials. Ensure that during use, servicing and disposal it is far away from fire.



WARNING: When positioning the appliance, ensure the supply cord is not trapped or damaged.

Do not modify or alter the specifications of the appliance in any way as this could cause a hazard and invalidate the warranty.

- This product is intended to be used in a household and similar applications such as:
 - Staff kitchen areas in shops, offices and other working environments.
 - Farmhouses and by clients in hotels, motels and other residential type environments.
 - Bed and breakfast type environments.
 - Catering and similar non-retail applications.



WARNING: Any electrical components (e.g., Plug, power cord, compressor) must be replaced by a certified service agent or qualified electrician.



WARNING: The light bulb supplied with this appliance is a special use bulb and is not suitable for domestic lighting.

- The power cord must not be lengthened or altered in any way.
- Make sure that the appliance is not positioned on or over the plug.
- Make sure that the power socket for the appliance is accessible once the appliance is installed.
- Do not pull the power cable, remove by pulling the plug.
- Do not use the plug socket if it is loose as there is a risk of electric shock.
- Do not operate the appliance without the lamp.
- The appliance is heavy, take care when moving.
- Do not touch items from the freezer compartment if your hands are damp/wet, as this can cause freezer burns.
- Avoid prolonged exposure to direct sunlight.
- It is not recommended to stand the appliance on a carpeted surface.
- Do not put hot/warm items directly against the rear wall.
- Frozen foods must not be re-frozen once they have been thawed out.
- Always follow the storage specifications indicated by the food manufacturer.
- Do not place carbonated or fizzy drinks in the freezer compartment as this creates pressure in the container and may cause it to explode, resulting in damage to the appliance.
- To avoid contamination of food, pay attention to the following:
 - Opening the door for long periods can cause a significant increase of the temperature in the compartments of the appliance.
 - Clean regularly surfaces that can encounter food and accessible drainage systems.
 - Clean water tanks if they have not been drawn for 5 days.
 - Store raw meat and fish in suitable containers in the refrigerator so that it is not in contact with or cannot drip onto other food.

- Two-star frozen food compartments are suitable for storing pre-frozen food, storing or making ice-cream and making ice cubes.
- One-, two- and three-star compartments are not suitable for freezing fresh food.
- If the refrigerating appliance is left empty for long periods, switch off, defrost, clean, dry and leave the door open to prevent mould developing within the appliance.



WARNING: Any electrical repairs or servicing must be carried out by a qualified electrician.

Inadequate repairs may result in a major source of danger for the user and invalidate the warranty. The appliance must be serviced by an authorised service centre and only genuine spare parts must be used.

The table below contains general guidelines on the storage of food in refrigerated appliance.

Refrigerator location	Type of Food
Fridge door	<ul style="list-style-type: none"> • Foods with natural preservatives such as jams, juices, drinks and condiments. • No perishable foods.
Salad Crisper Drawer	<ul style="list-style-type: none"> • Fruits, herbs and vegetables. • No bananas, onions, potatoes or garlic.
Top Fridge Shelf	<ul style="list-style-type: none"> • Pre-cooked foods such as ready-to-eat meals, deli meats and leftovers.
Middle Fridge Shelf	<ul style="list-style-type: none"> • Dairy products and eggs.
Bottom Fridge Shelf	<ul style="list-style-type: none"> • Raw meat, poultry and fish (only for a short-term).
Freezer Drawers	<ul style="list-style-type: none"> • Foods for long-term storage. • Top drawer - ice cream, frozen fruit and frozen baked goods. • Middle drawer - frozen vegetables and chips. • Bottom drawer - raw meat, poultry and fish.

SPECIFICATION

Supplier Name/Trade Mark	Statesman
Model Number	TNF1860WE/TNF1860XE
Category Type	Refrigerator - Freezer
Energy Efficiency Class	E
Annual Energy Consumption	249kWh/Annum
Total Net Storage Volume (Litre)	323L
Freezing Capacity	6.4kg/24 hours
Fridge Net Storage Volume (Litre)	219L
Freezer Net Storage Volume (Litre)	104L
Applicable Star Rating of Freezer Compartment	4 Star
Refrigeration System	Total No Frost
Temperature Rise Time	10.5 hours
Climate Class	SN/N/ST
This appliance is intended to be used at an ambient temperature between 10°C and 38°C	
Noise Emission (dB)	40 dB
Built-in appliance	No
Voltage (V)	220-240
Wattage Power (W)	110
Frequency (Hz)	50

Ambient Room Temperature Limits

Class	Symbol	Ambient average temperature °C
Extended temperature	SN	+10 to +32
Temperature	N	+16 to +32
Subtopical	ST	+16 to +38
Tropical	T	+16 to +43

APPLIANCE OVERVIEW



This illustration is only for reference, for details please check your appliance.

INSTALLATION

Important: Unpack the appliance and check if there are damages. Do not connect the appliance if it is damaged.

- The appliance must stand vertically on a flat, even surface. To level the appliance, use the levelling feet by turning them until the appliance is as level as possible.
- It is not recommended to stand the appliance on a carpeted surface.
- This appliance must be left to stand in an upright position for at least 4 hours before being switched on for the first time to allow the coolant gases time to settle after the appliance is in place.
- The appliance should not be placed near to sources of heat e.g. cookers, radiators, direct sunlight or in any unheated rooms e.g. garages or outhouses, as extreme temperatures will affect the performance of your appliance.
- Make sure the plug is accessible after installation.
- Do not expose the appliance to damp conditions, open air or rain.
- Do not lift the appliance by the pipes or the door when moving.
- This appliance is not intended to be used as a built-in appliance.
- Never place the appliance in a wall recess, fitted cabinet or furniture as this will not allow adequate ventilation and cause a potential fire hazard.

Allow 50mm of space at the sides and above the appliance to allow for adequate ventilation. It is not recommended to position the appliance under an overhanging wall unit. Leave enough space for the doors to be fully opened.



WARNING: It must be possible to disconnect the appliance from the mains power supply. The plug must be accessible after installation.

Levelling the Unit

Adjust the two leveling feet at the front of the unit.

If the unit is not level, the doors and magnetic seal alignments will not be covered properly.

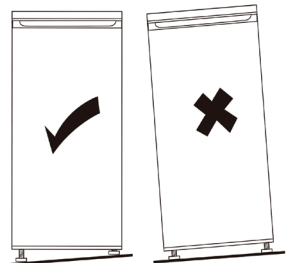

Reversing the Door

IMPORTANT: Ensure that the unit is switched off, unplugged and empty.

The appliance door can be fitted to open to either the left or the right depending on its location. The appliance will have to be tilted and supported to carry this out. It is advisable to get some help during this procedure.

Tools required: Phillips screwdriver, flat head screwdriver, hexagonal spanner.

Left Door Hinge Cover x1

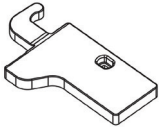

Left Closing-Aid on Upper Door x1

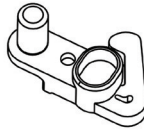

Left Closing-Aid on Lower Door x 1

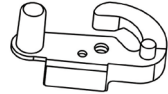

1. Remove the top hinge cover and disconnect the door switch and harness connectors.

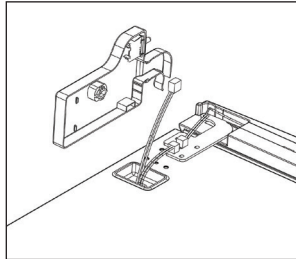
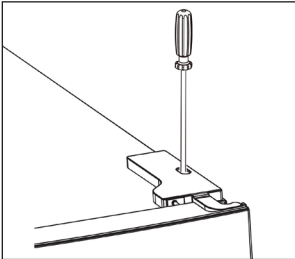

2. Unscrew the top hinge.

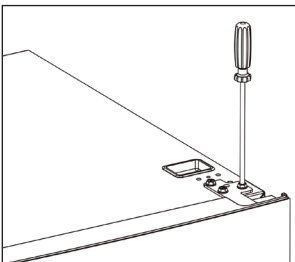

3. Remove the pin using a screwdriver. Flip the hinge bracket over 180° and then refit the pin.

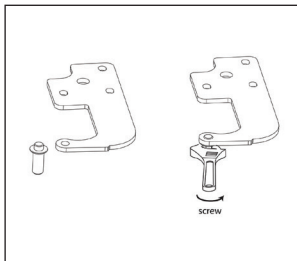
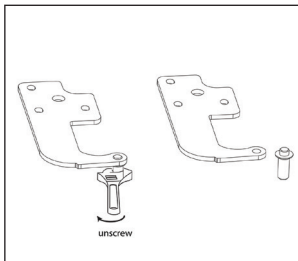

4. Remove the door switch from the existing hinge cover and attach to the replacement (opposite) hinge cover.

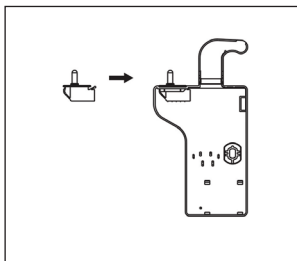
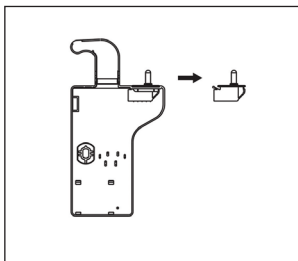

5. Remove the upper door cover and move the harness from one side to the opposite side. Reattach the door cover.

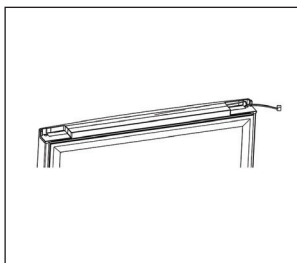
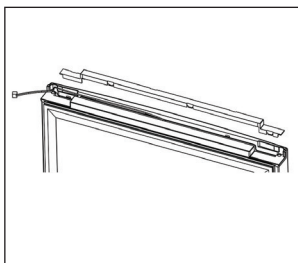

6. Unscrew the rectangular cover and reattach on the opposite side.

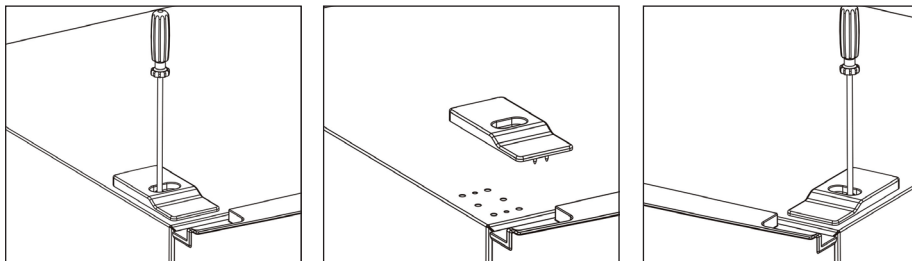

7. Remove the upper door and remove the hinge situated between the upper and lower door using a phillips screwdriver. Then remove the lower door.

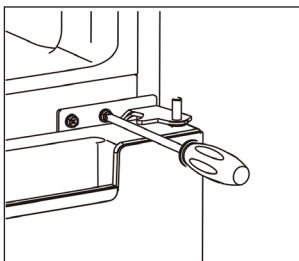

8. Remove the hinge hole covers from one side and reattach them on the other side.

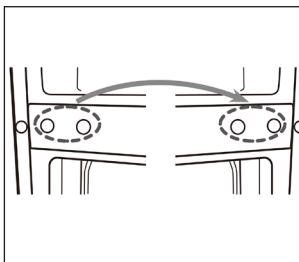

WARNING! When moving the appliance, always seek assistance.

9. Lay down the fridge freezer and then remove the levelling feet from both sides.

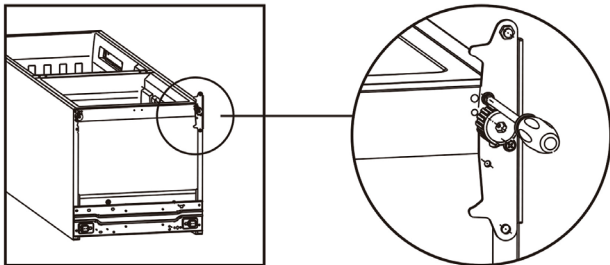

10. Using a spanner, unscrew the bottom hinge pin. Flip the bracket over and then refit the pin.

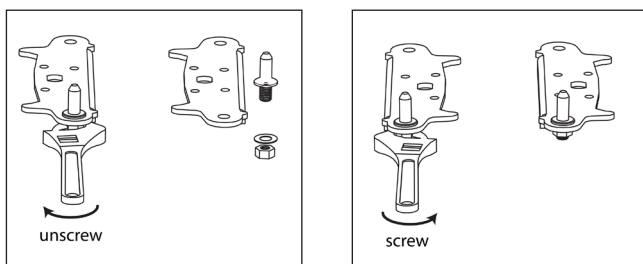

11. Screw the bottom hinge pin in to the opposite side.

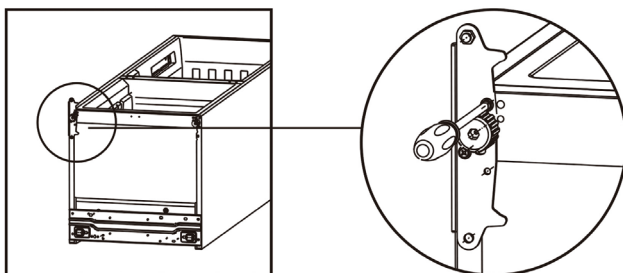

12. Remove the closing-aids from the bottom of both the upper and lower doors. Use the replacement (opposite) closing-aids and attach them to the opposite side.

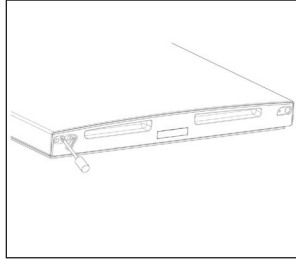
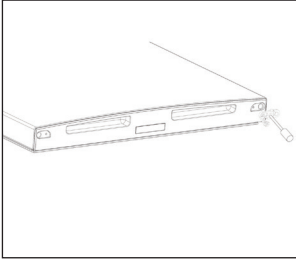

13. Remove both the fridge and freezer door seals, rotate them 180° and reattach.

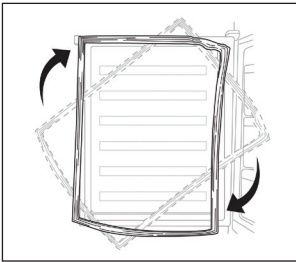

14. Replace the lower door and fix the hinge situated between the upper and lower door.

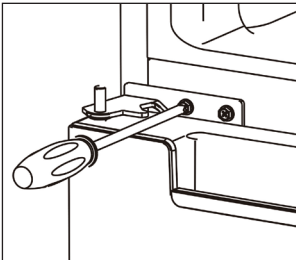

15. Replace the upper door, ensuring that the door is correctly aligned. If the door is not, the seal may not seal tightly during use. Connect the door to the unit by tightly screwing in the top hinge.

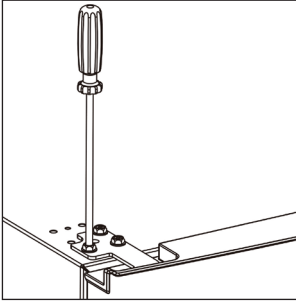

16. Connect the harnesses between the door and the unit. Attach the top hinge cover ensuring that the terminals of the door switch are connected.

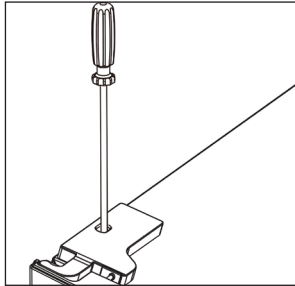
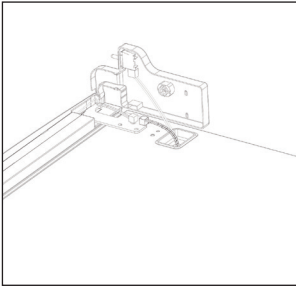

OPERATING INSTRUCTIONS

IMPORTANT: Before using the appliance for the first time, wash the interior and all the internal accessories with lukewarm water and some neutral soap to remove the typical smell of a new product, then dry thoroughly.

IMPORTANT: Do not use abrasive detergents or powders, as they will damage the finish of the appliance.

Using the Control Panel

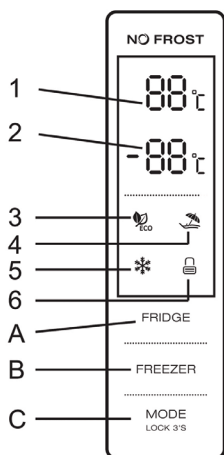

1. Temperature of Fridge Compartment
2. Temperature of Freezer Compartment
3. ECO Mode
4. Holiday Mode
5. Super Freeze Mode
6. Lock / Unlock

- A. Temperature Control of Fridge Compartment
- B. Temperature Control of Freezer Compartment
- C. Mode / Locking / Unlocking

- When switching on the appliance the control panel will illuminate for 3 seconds, and will operate with the mode and temperature set before the appliance was switched off. The panel will then automatically lock 25 seconds after the last operation. After locking, the light of the panel will show for an additional 30 seconds before switching off.
- Both preset temperatures of the fridge compartment and freezer compartment will be shown on the display.

Display



The panel will light up for 2 minutes once the door of the fridge compartment or freezer compartment is opened (one door signal is sensed at a time).

The panel will be lit up by any operation and the light will turn off 2 minutes after the last operation.

Display during normal operation:

- Temperature Display of the Fridge Compartment: Indicates the temperature of the current setting.
- Temperature Display of the Freezer Compartment: Indicating the temperature of the current setting.

Recommended Temperature Setting

Temperature setting recommendation		
Environment Temperature	Fridge Compartment	Freezer Compartment
Summer		
Normal		
Winter		

The information above gives users recommendation of temperature setting.

To avoid food waste, please refer to the recommended setting and storage times found in the user manual.

To optimize freezing speed and get more storage space, the freezer compartment can be used without the freezer drawers.

The quantity of fresh food that can be frozen in a specific time period is indicated on the rating plate. Load limits are determined by baskets, flaps, drawers, shelves etc. Make sure that these component can still close easily after loading.

Daily Use

To avoid contamination of food, please follow the below instructions.

- Opening the door for long periods can cause a significant increase of the temperature.
- Regularly clean surfaces that can come in contact with food.
- Store raw meat and fish in suitable containers in the refrigerator, so that it is not in contact with or drips onto other food.
- If the appliance is left empty for long periods, switch off, defrost, clean, dry and leave the door open to prevent mould developing within the appliance.

Place food in different compartments following the advise in the below table:

Compartment	Type of Food
Door or door shelves of the fridge compartment	Foods with natural preservatives such as jams, juices, drinks and condiments. No perishable foods.
Salad drawer	Fruits, herbs and vegetables. Do not store bananas, onions, potatoes or garlic in the salad drawer.
Fridge shelf – top	Foods that do not need to be cooked such as ready-to-eat foods, deli meats and leftovers.
Fridge shelf – middle	Dairy products and eggs.
Fridge shelf - bottom chiller	Raw meat, poultry and fish. Short term storage only.
Freezer drawers/shelves	<ol style="list-style-type: none">1. Foods intended to be stored long-term.2. Top drawer/shelf: ice cream, frozen fruit and frozen baked goods.3. Middle drawer/shelf: frozen vegetables and chips.4. Bottom drawer/shelf: raw meat, poultry and fish.

Fresh Converter Drawer Temperature Control

- Temperature of the fresh converter drawer can be adjusted to best suit the food stored.
- Push the slider control up and the temperature in the fresh zone will gradually decrease.
- When the slider control is placed at the “CRISPER” position the fresh converter drawer will function as a crisper zone and will maintain the appropriate temperature and humidity for fruits and vegetables.
- When the slider control is placed at the “CHILLER” position, it is suitable for short-term storage of fish or other fresh food. The food will keep fresh and will not freeze which makes it ideal for storing fresh food.
- When the “CHILLER” function is selected, it is recommended that the refrigerator temperature is set below 4°C. It is suggested to use this for no longer than 3 days, to ensure the food is fresh as possible.



CHILLER

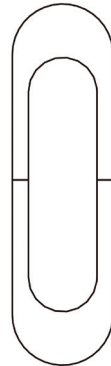

CRISPER

DISPLAY KEY FUNCTIONS

Temperature Control of the Fridge Compartment

This function can be used in both the User Defined Mode as well as Super Freeze Mode. After entering the temperature control of the fridge compartment, this button will flash. By touching the key consecutively, the temperature will change in a cycle of “2°C, 3°C, 4°C, 5°C, 6°C, 7°C, 8°C, after which 5-second flashing means the temperature has been selected.

Shutoff of the Fridge Compartment

Press the button for “Temperature Control of Fridge Compartment” and select “OFF”, the display will then flash for 5 seconds meaning the temperature has been selected and the fridge compartment will stop operating.

Temperature Control of the Freezer Compartment

This button can be used in both the User Defined Mode as well as Holiday Mode. After entering the temperature control of the freezer compartment, the button will flash. By pressing this consecutively, the temperature will change in a cycle from -14°C to -22°C, after which a 5-second flashing means the temperature has been selected.

Mode / Selection

By pressing this button repeatedly, the operation mode will cycle through 'ECO Mode - Holiday Mode - Super Freeze Mode - User Defined Mode'. Once the desired mode has been selected the display will flash for 5 seconds.

Lock / Unlock

Press MODE button and hold for 3 seconds to lock other two buttons, then the LOCK icon will show following a beep.

To unlock, press MODE button and hold for 3 seconds, then LOCK icon will show unlocked following a beep. In the unlocked mode, all buttons can be used. If there is no interaction with the display within 25 seconds, the display will be locked automatically. Press "MODE" button to show the display.

Press Button Alert

Short beep after pressing each button. Buttons only operational when display is unlocked.

Auto Lock Function

The display will automatically lock if not used for 25 seconds.

ECO mode

Press MODE button to choose ECO mode. After flashing for 5 seconds the ECO icon will stay illuminated meaning the ECO mode has been confirmed. In ECO mode, the refrigerator will automatically set the temperature of the fridge compartment to 5°C, and the temperature of the freezer compartment to -18°C. Apart from the MODE button, no other buttons will respond when this is engaged. Press the MODE button to exit the ECO mode.

Holiday Mode

Press the MODE button to choose the Holiday mode. After flashing for 5 seconds, the Holiday mode icon will stay illuminated meaning the Holiday mode has been confirmed.

In Holiday mode, the temperature of the fridge will be set at 17°C. The “FRIDGE” button will not respond when this is engaged. Press the “MODE” button to exit Holiday mode.

Super Freeze Mode

Press the MODE button to select the Super Freeze mode. The Super Freeze icon will flash for 5 seconds and then the function will be confirmed. In the Super Freeze mode, the “FREEZER” button will not respond.

To exit Super Freeze mode:

- Change the mode by using the MODE button
- Or after 50 hours of the Super Freeze mode being engaged, the refrigerator will automatically revert to the previous setting.

If you plan to freeze a large amount of food at the same time, set the Super Freeze mode at least 24 hours before hand.



WARNING: In the Super Freeze mode, the refrigerator will be louder.

Freezing Fresh Food

- The freezer compartment is suitable for freezing fresh food and storing frozen and deep frozen food for a long time.
- Place the fresh food to be frozen in the bottom compartment.
- The maximum amount of food that can be frozen in 24 hours is specified on the rating plate.
- The freezing process lasts 24 hours: during this period do not add other food to be frozen.

Storing Frozen Food

When first starting-up the appliance or after a period out of use, make sure to let the appliance run at least 2 hours on the higher settings before putting any products in the freezer compartment.

Important! In the event of accidental defrosting, the defrosted food must be consumed quickly or cooked immediately and then re-frozen (after cooking). Please check the product specifications for the “temperature rising time” in the scenario of a power outage.

Door open alarm

If the fridge (upper) door is open for longer than 60 seconds, the alarm will ring periodically until it is closed.

CLEANING AND MAINTENANCE

IMPORTANT: Switch off the electrical supply and remove the plug from the mains socket before carrying out cleaning or maintenance.



WARNING: Do not use abrasive cloths, powders, household cleaners, bleach, or wax polish to clean the appliance as these can leave a smell in the appliance and can damage the exterior.

Before First Use

Before using the appliance for the first time, wash the interior and all internal accessories with lukewarm water and some neutral soap to remove the typical smell of a brand new product, then dry thoroughly.

IMPORTANT: Do not use detergents or abrasive powders, as these will damage the finish.

Interior

1. The interior of the refrigerator should be cleaned regularly to avoid odour.
2. Remove all food from the appliance and cover to help keep it cool.
3. Remove all the drawers and shelves carefully from the appliance and wash in warm clean water with a soft cloth and dry thoroughly. Never replace the drawers when still wet.
4. Use a soft cloth or sponge to clean the inside of the refrigerator, with some baking soda and warm water. Rinse with water and wipe clean.
5. Open the door and allow the interior to dry naturally before replacing shelves and the salad drawer. The appliance should be fully dry before it is switched back on.
6. Plug in, switch on and allow the temperature in the appliance to drop back to an adequate temperature.
7. Replace the food in the appliance.

Exterior

Use a clean, soft cloth dampened in soapy water to wipe the exterior surface of the appliance and then dry thoroughly. Use a vacuum cleaner to remove dust from underneath the appliance and from around the compressor which is situated at the back of the appliance. Do this regularly to maintain adequate ventilation. Be careful not to damage the coolant system.

Door Seal

Use a clean, damp soft cloth to wipe the door seal and in between the creases, take care to avoid damaging the door seal as this will affect the performance of your appliance.

Drainage Channel

The drainage channel must be cleaned regularly to prevent a build-up of impurities.

TROUBLESHOOTING GUIDE

If you are having problems with your appliance, please use our troubleshooting guide below. If you are unable to resolve the issue using this guide please ring our Customer Service Department on 01473 277 508. Please have the model code and purchase information available.

Fault	Possible Cause	Solution
Appliance does not work.	Mains plug is not plugged in or is loose.	Insert mains plug.
	Fuse has blown or is defective.	Check fuse, replace if necessary.
	Socket is defective.	Mains malfunctions are to be corrected by an electrician.
Appliance freezes or cools too much.	Temperature is set too cold or the appliance runs on the Super Freeze mode.	Turn the temperature regulation knob to a warmer setting temporarily.
The food is not frozen enough.	Temperature is not properly adjusted.	Please refer to the initial 'Temperature Setting' section.
	Door was open for an extended period.	Open the door only as long as necessary.
	A large quantity of warm food was placed in the appliance within the last 24 hours.	Turn the temperature regulation to a colder setting temporarily.
	The appliance is near a heat source.	Please refer to the 'Installation' section.
Unusual noises.	Appliance is not level.	Re-adjust the feet.
	The appliance is touching the wall or other objects.	Move the appliance slightly.
Side panel is hot.	The condenser inside the panel is running.	This is normal.

FUSE REPLACEMENT (CLASS I)

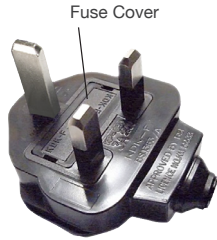

Fuse Replacement (Class I)

This appliance must be earthed. Remove the fuse cover with a small flat head screw driver. Take out the fuse and replace with a new fuse of the same Amp. Replace the fuse cover and push back into place.

DISPOSAL INFORMATION

The European Directive 2012/19/EU on Waste Electrical and Electronic Equipment (WEEE), requires that old household electrical appliances must not be disposed of in normal unsorted municipal waste.

Old appliances must be collected separately in order to optimise the recovery and recycling of the materials they contain and reduce the impact on human health and the environment.

The crossed out “wheeled bin” symbol on the product reminds you of your obligation, that when you dispose of the appliance it must be separately collected. Consumers should contact their local authority or retailer for information concerning the correct disposal of their old appliance.



STATESMAN WARRANTY/GUARANTEE TERMS & CONDITIONS

THANK YOU FOR CHOOSING STATESMAN

As a valued customer we would like to offer you a **FREE 2-year warranty** to cover your product against any electrical or mechanical defects.

This means that in the unlikely event you develop a fault or problem with your product we will happily repair or replace the item free of charge.

To qualify for the guarantee, the product must be used for domestic household use only and in accordance with the instructions in the user manual. Any misuse of the product will result in the warranty being void.

The guarantee does not cover accidental damage, misuse, neglect, tampering or incorrect adjustment or installation.

The guarantee will be rendered invalid if the product is resold, has had its serial number or rating label removed (or has an invalid serial number or rating label), or if an unauthorised person has carried out any repairs or alterations.

The warranty does not cover accessories or consumable parts that require replacement under normal use. This includes shelving, dials, filters, belts and trays etc.

In the unlikely event of a breakdown please refer to the Troubleshooting Guide in your user manual and check all plugs, fuses and the electricity supply.

If you still require assistance, please contact our Customer Service Department on **01473 277 508** or write to us at the following address:

Customer Service Department
38 Bluestem Road, Ransomes Industrial Estate, Ipswich, IP3 9RR

Please quote the Product Code and the PO number on the rating label and give details of the exact fault. We will then decide whether to replace the item.

IMPORTANT NOTE: Before we arrange the replacement, you will be required to return a copy of your proof of purchase. Please retain your original.

If an item is replaced within the agreed warranty period, the warranty for the replacement item will be calculated from the purchase date of the original.

In the event that the product is inspected, and no fault is found, or the product is not within the guarantee period you will be charged for the repair and any carriage costs.

STATESMAN

kitchen appliances

38 Bluestem Road, Ransomes Europark, Ipswich, IP3 9RR
EU: Castle Electrical Factors Ltd., Dundalk, A91 KA9R, IR

01473 277 508

Disclaimer: Statesman operate a policy of continual improvement and development.
We therefore reserve the right to change/alter the specification and appearance of our appliances without prior notice.
All diagrams and images shown in this manual are for illustration purposes only.