

STATESMAN

kitchen appliances



VH160SS / VH160WH
60CM VISOR COOKER HOOD

Instruction Manual

Please read these instructions carefully before use and retain for future reference.
Before switching on your appliance – Always check for any damage that may have been caused in transit.

CONTENTS

Important Safety Instructions	3-4
Appliance Overview	5
Installation	6-12
Operating Instructions	13-14
Cleaning and Maintenance.....	15
Troubleshooting.....	16
Fuse Replacement	17
Disposal Information	17
Statesman Warranty Information.....	18-19

IMPORTANT SAFETY INSTRUCTIONS

Please ensure you read all instructions and warnings in this user guide prior to first use.

Keep this user guide for future reference.

- The installation and repair work must be undertaken by a qualified and competent person.
- The manufacturer disclaims all liability for any damage or injury caused as a result of not following the instructions of installation.
- The cooker hood supply should be 220V-240V~50Hz-60Hz
- Children less than 8 years of age shall be kept away unless continuously supervised.
- This appliance can be used by children aged from 8 years and above and persons with reduced physical, sensory or mental capabilities or lack of experience and knowledge if they have been given supervision or instruction concerning use of the appliance in a safe way and understand the hazards involved. Children shall not play with the appliance. Cleaning and user maintenance shall not be made by children without supervision.
- Cleaning and user maintenance shall not be made by children without supervision.
- When the hood is in repair, maintenance, replacement of parts, please pull out the plug to ensure the safety of people.
- Plug the power cord into the power socket outlet with earthing continuity terminal.
- The cooker hood is for home use only, not suitable for commercial purposes.
- The cooker hood and its filter mesh should be cleaned regularly according to the instructions.
- Do not use open flame, or allow oil to go beneath the appliance.
- Do not check the status of the filters whilst the cooker hood is operating.
- Do not touch the light bulb within half an hour after appliance is used.

- If any fault occurs with the appliance, please call after-sale service department.
- Please keep the kitchen well ventilated when in use.
- Prior to any maintenance or cleaning, ensure the power is off.
- Constantly check food frying to avoid the overheating of oil which may become a fire hazard.
- If the power cord is damaged, it must be replaced by the manufacturer, service agent or similarly qualified person in order to avoid a hazard.
- If the plug or cord is damaged, please call after-sale service centre.
- There is a fire risk if cleaning is not carried out in accordance with the instructions.
- In case of a damaged connecting wire, please refer to the manufacturer, after-sale service personnel or other qualified technicians.
- Use the unit according to the instructions to avoid fire hazard.
- There shall be adequate ventilation of the room when the range hood is used at the same time as appliances burning gas or other fuels.
- Do not flambé under the range hood.
- The air must not be discharged into a flue that is used for exhausting fumes from appliances burning gas or other fuels.
- To protect the main body from corrosion of the long term accumulation of dirt, the cooker hood should be cleaned with hot water & non-corrosive detergent every 2 months.

CAUTION: Accessible parts may become hot when used with cooking appliance.

APPLIANCE OVERVIEW

Components

1. Air Duct Assembly
2. Body
3. Filter Assembly

Also includes:

- Check Valve
- Air Outlet Cap
- Installation Screws

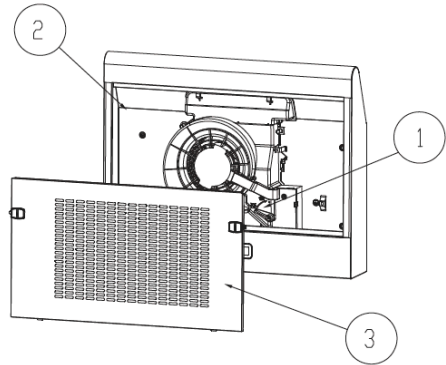

Selection of venting direction

- A. Ductless
- B. Vertical Discharge
- C. Horizontal Discharge

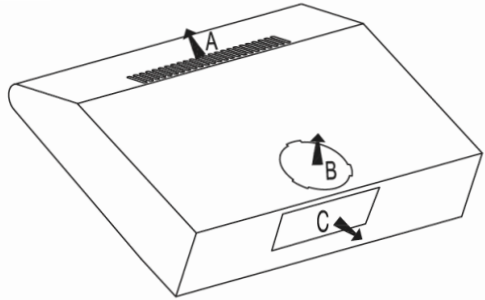

Important

The air must be discharged into a flue used for exhausting fumes from appliances burning gas or other fuels. Discharge regulations must be adhered to.

INSTALLATION

WALL DRILLING AND BRACKET FIXING

Please read the instructions carefully.

- Unpack the canopy and check that all functions are working. Ensure that the voltage (V) and the frequency (Hz) indicated on the rating plate match the voltage and frequency at the installation site.
- Check that the area behind the installation surface to be drilled is clear of any electrical cables or pipes, etc.
- The stainless steel and glass surfaces of the canopy are very easily damaged during installation if grazed or knocked by tools. Please take care to protect the surfaces during installation.
- Protect the cooker top surface below with cardboard, or the like, to prevent damage occurring whilst the wall canopy is being installed above.
- The manufacturer shall not be liable for failure to observe all safety regulations in force for the correct and normal operation of electrical parts.

Choose a venting mode:

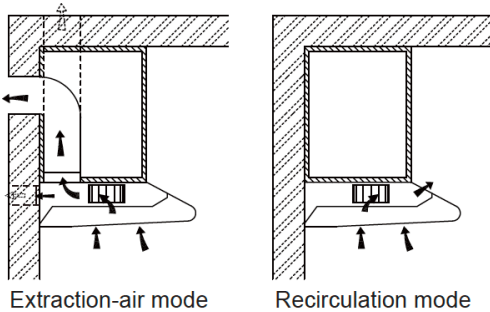

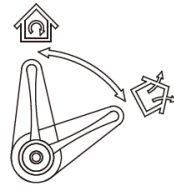

Extraction-air mode

Recirculation mode



Venting knob position

	Extraction-air mode: Turn the venting knob here means venting outside
	Circulating-air mode: Turn the venting knob here means recirculation



Recirculation Mode

Recirculation mode means that the air is re-circulated back into the kitchen. This method is suggested when heavy cooking with a lot of steam, smoke etc. It is not necessary to remove any duct knockouts for this. Filters should be used to help remove cooking odours. These must be cleaned and replaced regularly.

Once installed and after selecting the venting direction, you can move the slider (highlighted) to choose between recirculating air mode or Extraction air mode. Open the filter to access the slider.

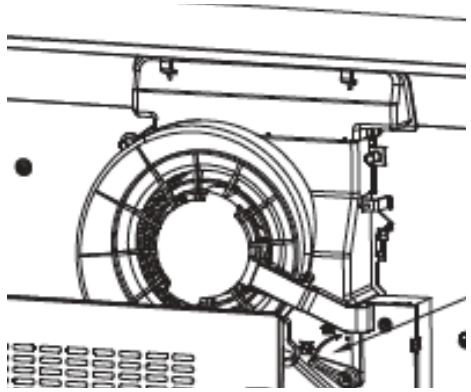

*Ensure that the duct knockouts are not removed when doing this.



IMPORTANT

Ensure sufficient air can access the cooker hood for correct and efficient exhaustion of gases. This will prevent any back drafting.

Government regulations must be observed for the extraction of air. If the extractor hood is used in circulating air mode with activated carbon filter, there are no operating restrictions. The room in which the ductless fan is place must be well vented.

Extraction-air mode

If you choose extraction-air mode, there are two methods for ventilation, including 'horizontal ventilation' and 'vertical ventilation'.

Please use a tool to take out the cover before using and install check valve on the hole.

The square air check valve for horizontal ventilation is not supplied.

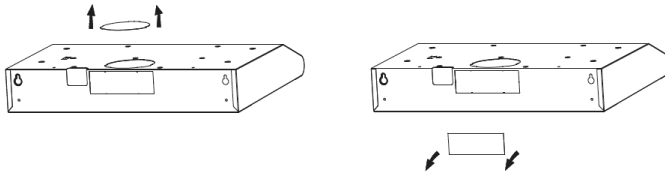

Ensure the power has been turned off before beginning this installation. The plug must be inserted into a socket close enough to final position of the cooker hood. To safely install this appliance it is advised to have 2 people assisting.

The following is required for installation:

- Drill
- Flat head screwdriver
- Phillips head screwdriver/cordless drill and Phillips head bit
- Tin snips
- 3/8" nut driver or ratchet with extension
- Measuring tape
- Hand saw or jig saw
- Electrical tap
- Duct tape

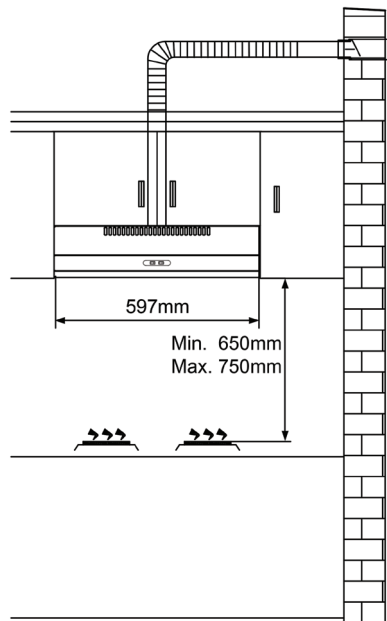

1. Remove the hood from the packaging.
2. Lay the hood upside down on a table covered with cardboard or paper to prevent scratching or scuff marks.
3. Hood Installation should be within 0.8m radius range.
4. It is recommend that the bottom of the hood should be less than 650mm and no more than 750mm above the heating elements and/or burners.



IMPORTANT

Installation work and electrical wiring must be done by a qualified person in accordance with all applicable codes and standards, including fire rated construction.

Exhaust-air mode

The exhaust air is extracted upwards via a ventilation shaft or directly through the outside wall.

The exhaust air must not be extracted into a function smoke flue or into a shaft which vents a room with a fireplace.

Extraction of exhaust air in a non-functioning smoke flue or exhaust gas flue must have consent from a qualified heating engineer.

If the extractor hood is in exhaust gas mode and a flue type heater is running at the same time (e.g. gas, oil, or solid-fuel heaters, continuous-flow heaters, water heaters etc.), ensure that it has sufficient air supply.

*For the cooker hood to operate safely it requires the low air pressure, in the room in which a fire place is located, to not exceed 4 Pa.

This low air pressure can be obtained providing that the combustion air can escape through non lockable openings, e.g. doors, windows, air intakes/wall vent boxes or by other technical methods, such as reciprocal interlocking.

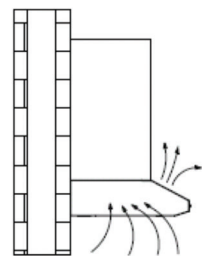
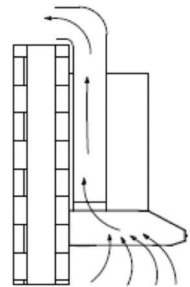



IMPORTANT

When assessing the air pressure, the ventilation system of the whole house/apartment must be taken into consideration, e.g. hob and gas cookers. Government regulations must be adhered to for the extraction of exhaust air. If the extractor hood is used without a duct (air circulating mode) but with an activated carbon filter, there are no operating restrictions.

Method 1 - Fixing to a Cupboard



IMPORTANT

Ensure that the cupboard is securely fitted to a wall and that it can take the weight of the cooker hood.

1. Drill 1 x 130mm diameter hole and 4 x 3.5mm diameter holes as shown in the below picture. Ensure that these perfectly align with the cooker hood.
2. **ATTENTION:** If the cooker hood is in air circulating mode it is not necessary to drill 130mm diameter hole.
3. Use the 4 screws to fix the cooker hood to a kitchen cupboard. To check that your fixings are correctly located, hold the cooker hood in place. If correct, then fit into position. Tighten the screws until secure.

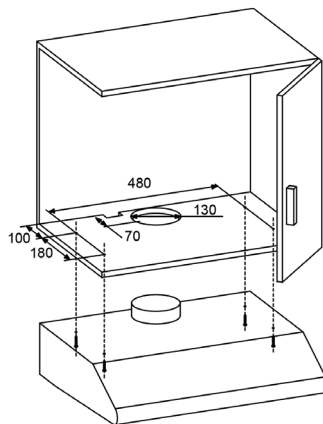

Method 2 - Attaching to the Wall



IMPORTANT

When cutting or drilling holes into the wall or ceiling, make sure not to damage electrical wiring or other hidden utilities.

1. To mount onto the wall, drill 2 x 10mm diameter holes, 538mm apart from one another as shown in the below picture. Make sure the hood is aligned directly over the hob and that it is level.
2. Insert two plastics wall plugs into the holes. These are supplied.
3. Insert two screws into the upper two plastic wall plugs and tighten them leaving 3mm protruding from the wall.
4. Mount the cooker hood onto the two screws and mark the bottom two screw positions.
5. Remove the hood and drill the bottom two screw holes and insert the other two plastic wall plugs.
6. Mount the hood back on to the top screws, insert the bottom screws and fully secure all four.

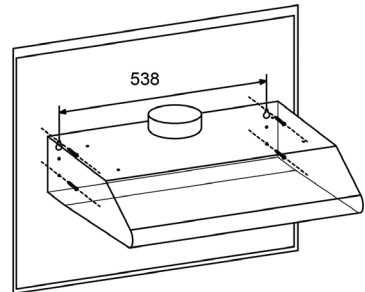

IMPORTANT

The cooker hood must not be installed and connected to flues of other appliances which run off energy which is not electricity, i.e. water heater boiled cookers such as ranges and agas.

Check Valve Installation

Hold the check valve, align the tabs and insert. Then spin until the tabs are hidden and then check the check valve is secure.

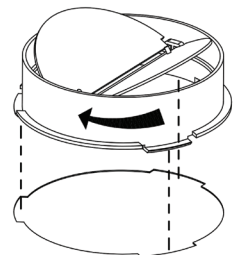

Carbon Filter Installation

1. Remove the grease filter and then remove the iron wire.
2. The filter cotton is located on the metal mesh and fixed by two iron wires.
3. To replace with a new carbon filter, reverse the steps to install.



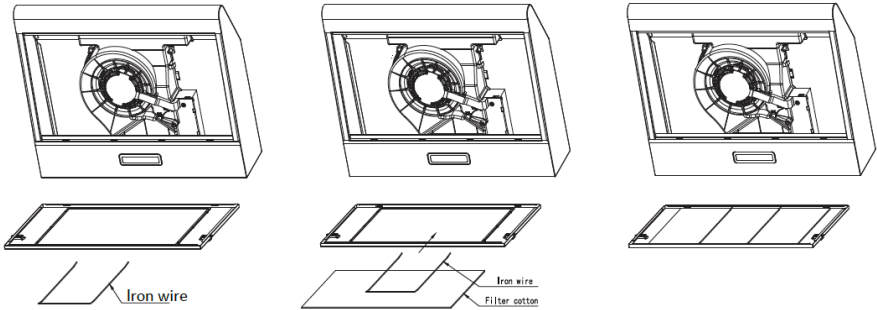

WARNING: The filter cotton cannot be washed or recycled. It should be replaced after approximately 2-3 months of use.

Please Note: Filter cotton is not supplied with your appliance.

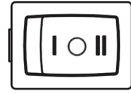
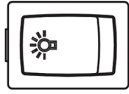

OPERATING INSTRUCTIONS



Light		Lamp On
		Lamp Off
Motor	O	Off
	I	Low
	II	High

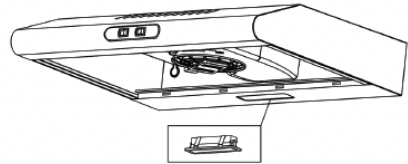
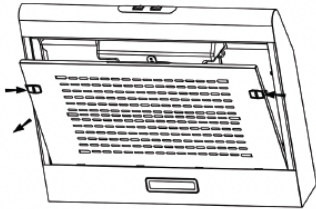

	Max Power	Voltage	Picture	ILCOS D Code
LED Modules (Self-ballasted)	1.5W	220-240V~	 Square/Diameter 33.2mmx120mm	DBS-1.5- H-33.2/120

Replacing the Bulb



IMPORTANT

Before replacing the light bulb double check that the cooker hood is secure.

1. Switch off the extractor hood and isolate it by removing the mains plug or switching off the fuse.
2. Remove the grease filter.
3. Remove the light by levering it out of the hood body. This may require some pressure or force. Ensure that this is not excessive and done so carefully.
4. Disconnect the light connection.
5. Replace the light with a new bulb (same model). Make sure that the light connection is attached correctly.
6. Reconnect the power by inserting the mains plug or by switching on the fuse.

CLEANING & MAINTENANCE

Disconnect range hood from power supply before cleaning or servicing.

1. Cleaning the surface of hood frequently. Use mild soap or detergent to clean the hood.
2. Do not use harsh abrasives.
3. Avoid the use of scouring powders or dishwasher compounds.
4. Grease may be washed using mild soap or detergent.
5. Charcoal filter cannot be cleaned and must be replaced regularly.



IMPORTANT

When cleaning, water must not enter the motor, control switch or electrical parts.

It is recommended to clean the metallic filter every 3 months by carrying out the following instructions:

1. Remove the metallic filter from the cooker head and wash it in a solution of water and neutral liquid detergent, leaving to soak.
2. Rinse thoroughly with warm water and leave to dry.
3. The metallic filter may alter in colour after several washes.
4. This is not cause for concern or replacement of metallic filter.

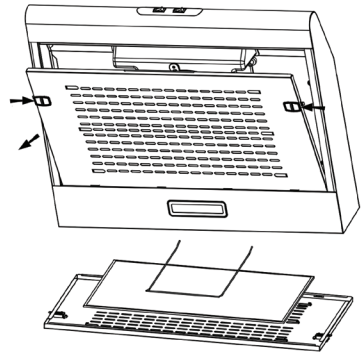

IMPORTANT

There is a fire risk if cleaning is not carried out in accordance with the instructions.

TROUBLESHOOTING

If you are having problems with your appliance, please use our troubleshooting guide below. If you are unable to resolve the issue using this guide please ring our Customer Service Department on 01473 277 508. Please have the model code and purchase information available.

Please Note: Any repairs should be done by a qualified technician.

Fault	Cause	Solution
Light on, but motor does not work	The blades are blocked	Remove blockage
	The capacitor is damaged	Replace capacitor
	The motor is damaged	Replace motor
	The internal wiring of motor is cut off/disconnected. An unpleasant smell may produce	Replace motor
Both light and motor do not work	Apart from the above mentioned, check the following:	
	Light damaged	Replace lights
	Power cord loose	Connect the wires as per the electrical diagram
Vibration	The blade, if damaged, can cause vibrating	Replace the blade
	The motor is not tightly fastened	Fasten the motor tightly
	The cooker hood is not tightly fixed	Fix the cooker hood tightly
Insufficient suction	The distance between the cooker and the cooker top is too large	Readjust the distance
	Too much ventilation from open doors or windows	Choose a new place to install the appliance or close some doors/ windows
The machine inclines	The fixing screws are not tight enough	Tighten the fixing screw and make it horizontal
	The hanging screws are not tight enough	Tighten the hanging screw and make it horizontal

FUSE REPLACEMENT (CLASS I)

This appliance must be earthed. Remove the fuse cover with a small flat head screw driver. Take out the fuse and replace with a new fuse of the same Amp. Replace the fuse cover and push back into place.

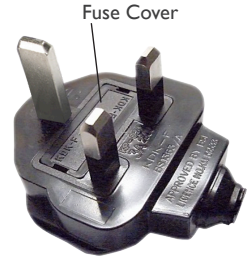

DISPOSAL INFORMATION

The European Directive 2012/19/EU on Waste Electrical and Electronic Equipment (WEEE), requires that old household electrical appliances must not be disposed of in normal unsorted municipal waste.

Old appliances must be collected separately in order to optimise the recovery and recycling of the materials they contain and reduce the impact on human health and the environment.

The crossed out “wheeled bin” symbol on the product reminds you of your obligation, that when you dispose of the appliance it must be separately collected. Consumers should contact their local authority or retailer for information concerning the correct disposal of their old appliance.



STATESMAN WARRANTY/GUARANTEE TERMS & CONDITIONS

THANK YOU FOR CHOOSING STATESMAN

As a valued customer we would like to offer you a **FREE 2-year warranty** to cover your product against any electrical or mechanical defects.

This means that in the unlikely event you develop a fault or problem with your product we will happily repair or replace the item free of charge.

To qualify for the guarantee, the product must be used for domestic household use only and in accordance with the instructions in the user manual. Any misuse of the product will result in the warranty being void.

The guarantee does not cover accidental damage, misuse, neglect, tampering or incorrect adjustment or installation.

The guarantee will be rendered invalid if the product is resold, has had its serial number or rating label removed (or has an invalid serial number or rating label), or if an unauthorised person has carried out any repairs or alterations.

The warranty does not cover accessories or consumable parts that require replacement under normal use. This includes shelving, dials, filters, belts and trays etc.

In the unlikely event of a breakdown please refer to the Troubleshooting Guide in your user manual and check all plugs, fuses and the electricity supply.

If you still require assistance, please contact our Customer Service Department on **01473 277 508** or write to us at the following address:

Customer Service Department
38 Bluestem Road, Ransomes Industrial Estate, Ipswich, IP3 9RR

Please quote the Product Code and the PO number on the rating label and give details of the exact fault. We will then decide whether to replace the item.

IMPORTANT NOTE: Before we arrange the replacement, you will be required to return a copy of your proof of purchase. Please retain your original.

If an item is replaced within the agreed warranty period, the warranty for the replacement item will be calculated from the purchase date of the original.

In the event that the product is inspected, and no fault is found, or the product is not within the guarantee period you will be charged for the repair and any carriage costs.

STATESMAN

kitchen appliances

UK Address: 38 Bluestem Road, Ransomes Europark, Ipswich, IP3 9RR

EU Address: Castle Electrical Factors Ltd., Dundalk, A91 KA9R, IR

01473 277 508